

OLED Color View Finder

Operating Instructions

Before operating the unit, please read this manual thoroughly and retain it for future reference.

DVF-EL100

Table of Contents

Overview	3
Usage Notes.....	3
Parts Identification	4
Attaching the Viewfinder to a Camera.....	5
Detaching the Viewfinder	6
Adjusting the Position	6
Adjusting the Left/Right Position	6
Adjusting the Forward/Backward Position and Height	7
Adjusting the Angle	7
Specifications	8

Overview

The DVF-EL100 is a 0.7-inch color OLED viewfinder. This unit has the following features.

Built-in OLED panel

The OLED (organic light-emitting diode) panel makes use of organic material that emits light when an electric current is applied. The organic material of the panel is self-emitting, and its luminance level can be controlled by the amount of electric current applied.

These properties bring about the following three features.

- **Quick motion picture response**

The luminescent state of the OLED panel can be changed instantaneously by changing the flow of the current applied to the organic material. This enables quick motion picture response and image production with minimal blurring and ghosting. Furthermore, the panel's performance is unaffected by changes in ambient temperature, allowing shooting in outdoor locations.

- **High contrast and dynamic range**

The OLED panel ceases light emission when a black-level signal is applied, enabling true black display. In addition, the panel's high peak brightness and ability to display brilliant whites in specific portions of the screen produce dazzling displays of glittering nighttime illuminations and stars, sparkling jewelry and glass, etc.

- **Rich color reproduction**

The self-illuminating OLED panel reproduces of a vast range of colors in virtually any shade or brightness.

High-performance loupe

The 4-group 5-element lens (including aspheric lens) produces pictures with low distortion while allowing adjustment over a wide range of visibility.

FOCUS MAG function

You can magnify the height and width of the image (x2) for easier focus adjustment.

False color function

Display signal levels using different colors. When you use the false color function, image signals are displayed in black and white, and colors are added based on the signal levels.

Tally indicator

The viewfinder is equipped with a single tally indicator (red) that lights in response to a tally signal.

For details on which cameras and camcorders can be connected to the unit, refer to the operating instructions for each device.

Usage Notes

Condensation

If the unit is suddenly taken from a cold to a warm location, or if ambient temperature suddenly rises, moisture may form on the outer surface of the unit and/or inside of the unit. This is known as condensation. If condensation occurs, turn off the unit and wait until the condensation clears before operating the unit. Operating the unit while condensation is present may damage the unit.

OLED panel

The OLED panel fitted to this unit is manufactured with high precision technology, giving a functioning pixel ratio of at least 99.99%. Thus a very small proportion of pixels may be "stuck", either always off (black), always on (red, green, or blue), or flashing. In addition, over a long period of use, because of the physical characteristics of the organic light-emitting diode, such "stuck" pixels may appear spontaneously. These problems are not a malfunction.

OLED display

Due to the characteristics of the material used in the OLED panel, permanent burn-in or reduction in brightness may occur.

These problems are not a malfunction.

Viewfinder lens

Do not leave the viewfinder lens facing toward a strong light source, such as sunlight.

Burnout of the OLED panel or fire may occur if the lens focuses the sunlight or other strong light source.

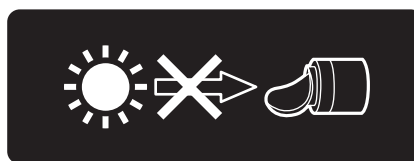

Maintenance

Be sure to perform the following maintenance after using the viewfinder at dusty locations, beaches, hot springs, or other harsh environments.

- Use an airbrush to carefully remove any dust or sand from inside the viewfinder.
- Clean the contacts of the connectors.
- After performing the above maintenance, perform a basic operation test and check that the viewfinder is functioning properly.

Parts Identification

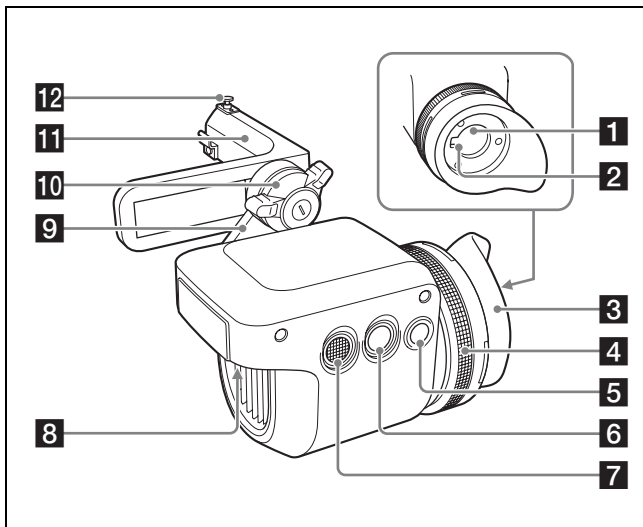

1 Tally indicator

This is located at the top of the unit's internal screen. This lights or blinks red or turns off according to the situation.

Lit: The camera/camcorder is recording.

Blinking: An error or warning has occurred.

For details on the status of the indicator, refer to the operating instructions for your camera/camcorder.

2 Eye sensor

3 Eyecup

4 Diopter adjustment ring

Turn the ring to adjust the diopter so that the image is clearly visible.

5 DISPLAY button

Displays markers and text information.

The display switches between display and hide with each press of the button.

6 SPARE button

When using the PMW-F5/F55 (version 2.00), this allows you to switch to false color display. This does not affect the camera's output signal.

The display switches between false color display and normal display with each press of the button.

7 FOCUS MAG (magnified display) button

Magnifies the height and width of the image (x2) for easier focus adjustment. This does not affect the camera's output signal.

The display switches between magnified display and normal display with each press of the button.

8 VF connector (26-pin rectangular type)

Connect this to the VF connector on the camera using the supplied VF connection cable.

9 Rotation arm

Rotate the arm to adjust the position of the unit.

10 Arm lock knob

Use this when adjusting the forward/backward position and height of the unit.

11 L-arm

Attach this to the viewfinder shoe of the camera.

You can also slide the unit forward, backward, left, and right to adjust its position.

12 Slide stopper

Prevents this unit from detaching from the camera when sliding it left and right.

Notes

- Do not cover or block the eye sensor.
- To prevent screen burn-in on the OLED panel and extend the life of the panel, the colors in the display may be inverted or the image may not be displayed when your eye is not in contact with the eyepiece. This will not occur when the camera or camcorder is recording.

Attaching the Viewfinder to a Camera

CAUTION

Do not leave the eyepiece lens facing toward the sun when the viewfinder is attached. Direct sunlight may enter and focus within the eyepiece lens, resulting in fire.

Note

Depending on the version of your PMW-F5/F55, an image may not be displayed. In such cases, contact a Sony service representative.

1 Attach the viewfinder to the camera.

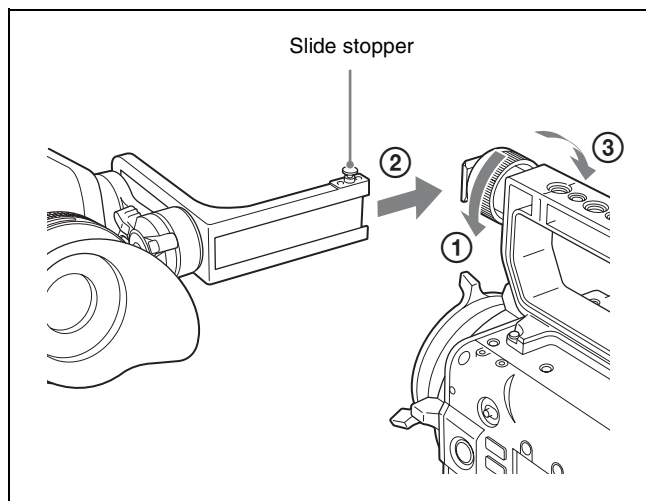

- ① Loosen the fixing ring on the camera's viewfinder shoe.
- ② Align the groove in the viewfinder's L-arm with the viewfinder shoe, and attach the viewfinder by sliding it horizontally. The slide stopper lowers automatically.
- ③ Tighten the fixing ring.

2 Connect the cable.

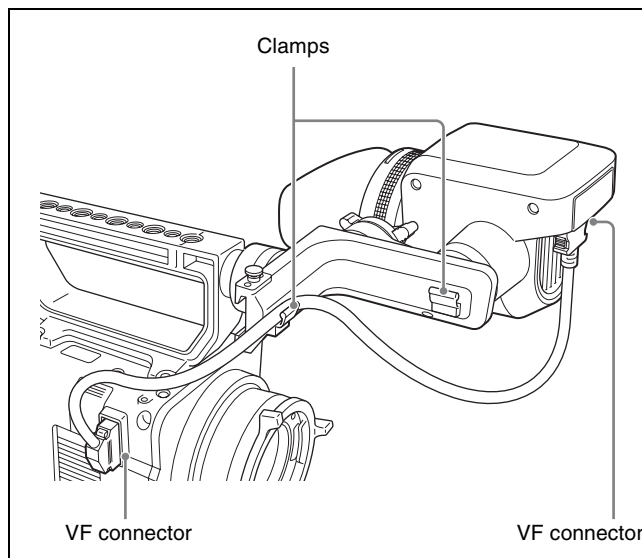

- ① Use the VF connection cable (supplied) to connect the viewfinder's VF connector to the camera's VF connector. Connect the straight connector to the viewfinder's VF connector and the angle connector to the camera's VF connector. Verify the orientations of the connectors, and insert them until they click into place.

- ② Secure the cable with the clamp if necessary.

Notes

- Always turn off the camera before connecting the VF connection cable to the VF connector on the camera. If you make the connection while the camera is on, the viewfinder may not function properly.
- Be sure to check the shape of the VF connection cable's connector, and insert it in the proper orientation.
- Fully insert the VF connection cable's connector into the VF connector and make sure it is secure. If the connector is not firmly connected, the image may be distorted and the tally indicator may not light properly.

Detaching the Viewfinder

- 1 Remove the VF connection cable from the clamp, and disconnect the connectors from the camera's VF connector and the viewfinder's VF connector.

Pull the connector straight out while pressing the lock release buttons on both sides of the connector.

Note

Forcibly pulling the connector without pressing the lock release buttons may damage the connector.

- 2 Loosen the fixing ring on the camera's viewfinder shoe.
- 3 Slide the viewfinder in the opposite direction from when you attached it, and raise the slide stopper to detach the viewfinder.

Adjusting the Position

Note

Rotating the viewfinder too much in a single direction while adjusting its position and angle may pull the VF connection cable and result in disconnection.

Adjusting the Left/Right Position

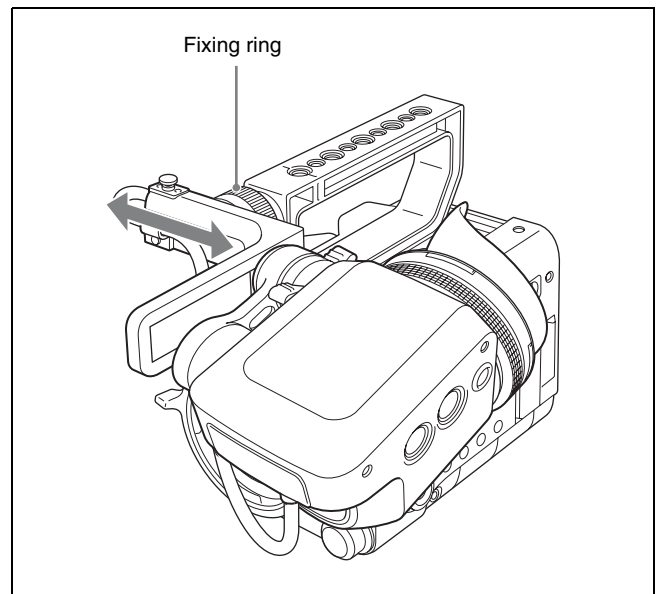

Loosen the fixing ring on the camera's viewfinder shoe, and slide the viewfinder left or right to adjust its position. When you finish adjustment, tighten the fixing ring to secure the position.

Adjusting the Forward/Backward Position and Height

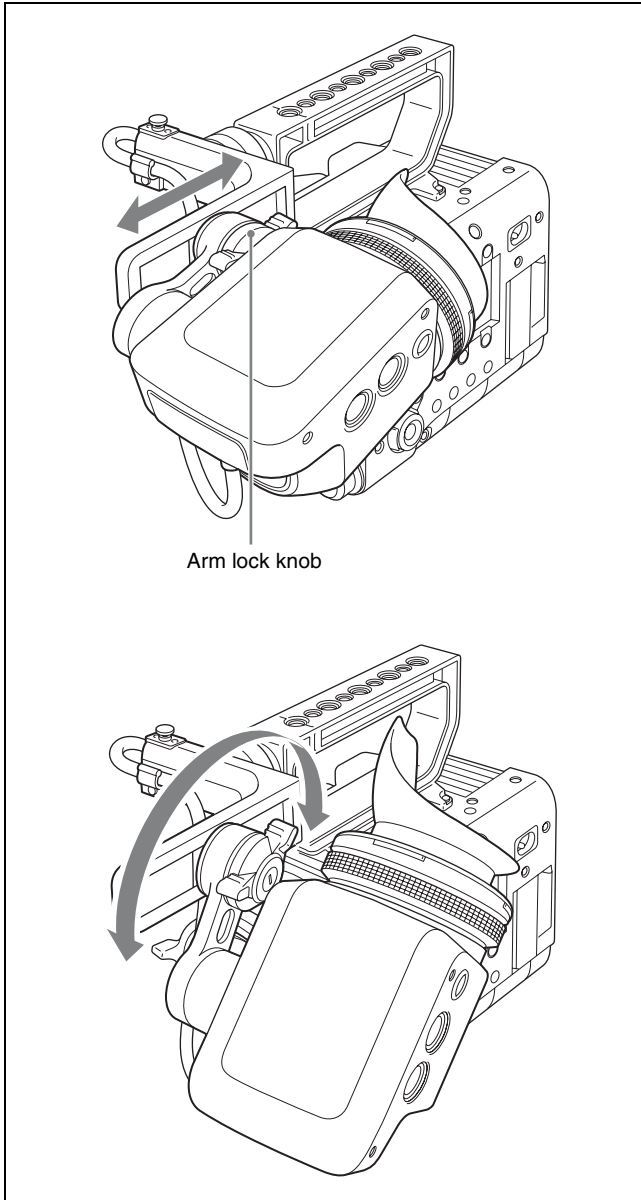

Turn the viewfinder's arm lock knob in the opposite direction of LOCK, then slide the viewfinder forward or backward and rotate the rotation arm to adjust its position. When you finish adjustment, turn the arm lock knob in the LOCK direction.

Adjusting the Angle

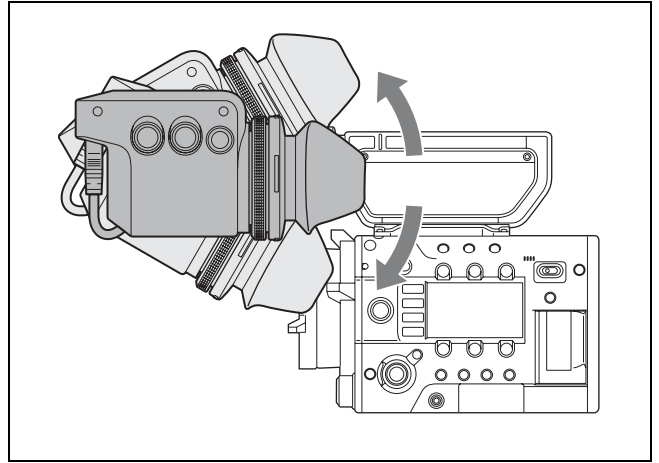

Hold the viewfinder and adjust its angle.

Specifications

General

Power supply

10.5 V to 17.0 V DC (supplied from the camera)

Power consumption

1.6 W

Operating temperature

0 °C to 40 °C (32 °F to 104 °F)

Storage temperature

-20 °C to +60 °C (-4 °F to +140 °F)

Mass

Approx. 750 g (1 lb 10.5 oz)

Dimensions

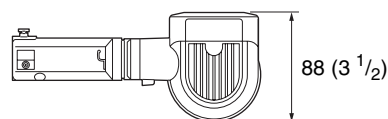
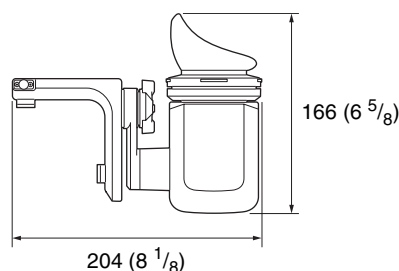

Unit: mm (inches)

Performance

Brightness

90 cd/m² (peak brightness, typical)

Resolution

1280 × 720

Color temperature

D65

Colors and signal levels displayed for false color (during S-Log2)

Color display	Signal level
Red	105.4% or higher
Yellow	102.4% to 105.4%
Pink	41.3% to 45.3%
Green	30.3% to 34.3%
Blue	2.5% to 4.0%
Purple	0% to 2.5%

Connector

VF connector: 26-pin rectangular type (1)

Supplied accessories

Before Using this Unit (1)

Operating Instructions (CD-ROM) (1)

VF connection cable (1)

Warranty (1)

Related accessories

Solid-State Memory Camcorder

PMW-F5, PMW-F55

Design and specifications are subject to change without notice.

Notes

- Always verify that the unit is operating properly before use. SONY WILL NOT BE LIABLE FOR DAMAGES OF ANY KIND INCLUDING, BUT NOT LIMITED TO, COMPENSATION OR REIMBURSEMENT ON ACCOUNT OF THE LOSS OF PRESENT OR PROSPECTIVE PROFITS DUE TO FAILURE OF THIS UNIT, EITHER DURING THE WARRANTY PERIOD OR AFTER EXPIRATION OF THE WARRANTY, OR FOR ANY OTHER REASON WHATSOEVER.
- SONY WILL NOT BE LIABLE FOR CLAIMS OF ANY KIND MADE BY USERS OF THIS UNIT OR MADE BY THIRD PARTIES.
- SONY WILL NOT BE LIABLE FOR THE TERMINATION OR DISCONTINUATION OF ANY SERVICES RELATED TO THIS UNIT THAT MAY RESULT DUE TO CIRCUMSTANCES OF ANY KIND.

<http://www.sony.net/>

Sony Corporation