



Camera

Worldwide Technical Bulletins for Broadcast and Professional Products

Date: **August 9, 1999**

Subject: **MANUAL CORRECTION—EXPLODED VIEW**

Model: **BKW-401**

Serial No: **ALL**

DESCRIPTION

Correct the BKW-401 Installation Manual, 1st Edition through 1st Edition (Rev. 2), as shown in Figure 1.

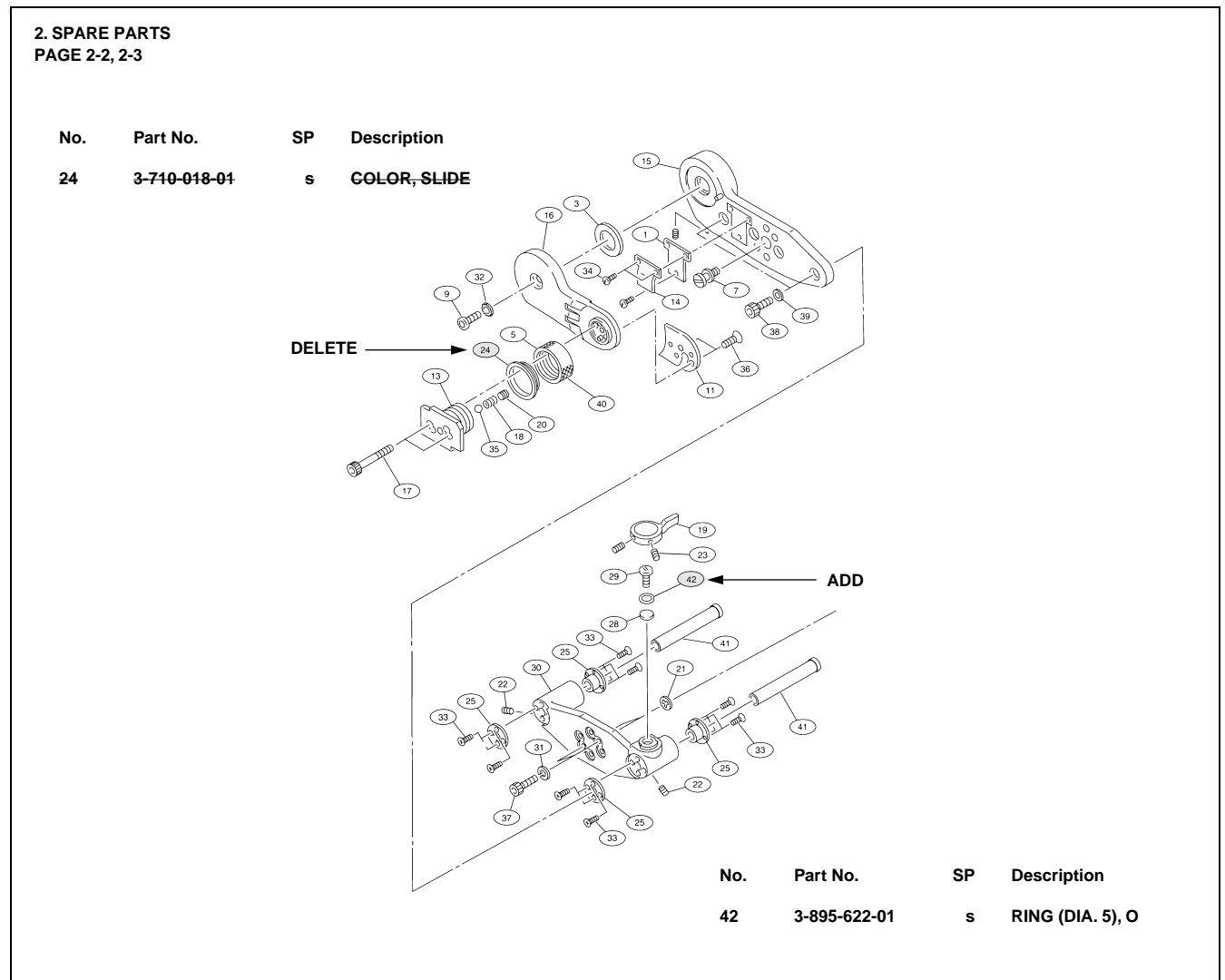

Figure 1