

**FUJIFILM**  
expect INNOVATION™

# HA PREMIER



**DIGI  
POWER**

**QuickZoom**

**HA22x7.3BE RM/RD**

*Technology That Inspires...*

**FUJINON**



Zoom Ratio/Format	22X / 2/3"
Focal Length	7.3 to 161 mm (2X) 14.6 to 322 mm
Maximum Relative Aperture	1:1.9 (7.3 ~ 113mm) 1:2.7 (161 mm)
Maximum Photometric Aperture T-No.	1:2.0 (7.3 ~ 113mm) 1:2.9 (161 mm)
Angular Field of View	7.3 mm 66° 36' x 40° 32'
16:9 Aspect Ratio	161 mm 3° 25' x 1° 55' (2X) 14.6 mm 36° 22' x 20° 55' 322 mm 1° 42' x 0° 58'
M.O.D. from Image Plane	1.18m
M.O.D. from Front of Lens	0.85m
Object Dimensions at M.O.D.	7.3 mm 1222 x 687 mm 161 mm 55 x 31 mm (2X) 14.6 mm 609 x 342 mm 322 mm 28 x 16 mm
Filter Size	ø 127 mm P=0.75 (On Hood)
Dia ø x Length (w/o Hood)	ø110 x 287.3 mm
Weight (w/o Hood)	3.15 kg / 3.22 kg*
Options	Ratio Converter / 16 Bit Encoder
Features	Inner Focus / Quick Zoom / Zoom Limit

\*RD contain servos for zoom and focus.

**ACCESSORIES: HD & SD ENG/EFP**

**THREE-MODE FINE FOCUS**

By shifting the sensitivity from the wide side to the telephoto side of the focus range, this control provides more precise focusing for studio or sports or sports.

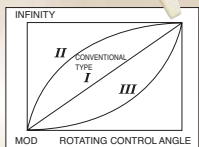

**SERIAL DIGITAL REMOTE CONTROL BY PC**

Remote control of zoom, focus and iris for Digipower lenses is possible via serial digital link, providing accurate positioning for virtual studio and other applications requiring digital precision.

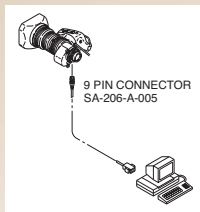

**DIGI ZOOM DEMAND\***

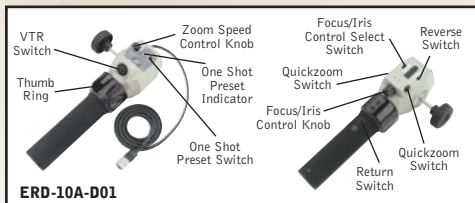

\*New Digital features only available on ERM/ERD-M/S.

- A. CFC-990 Flex Cable
- B. FMM-3B/6B Manual Module
- C. ZMM-6 Manual Module
- D. EBF-1 Focus Cable
- E. MCA-6
- F. ERD-20A-A02 Zoom Demand
- G. FSP-13G Focus Positional Module
- H. EPD-4A-E02
- I. CZH-14 Focus Handle
- J. CFH-11 Focus Handle
- K. MCA-7 Mounting Clamp
- L. EPD-20A-A01/A02 Focus Demand
- M. ERD-10A-D01 Zoom Demand
- N. ALH-117A-02A Support for HA36x/A36x HA42x

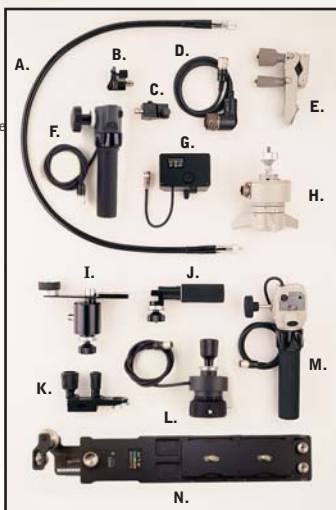

**DIGI POWER REAR CONTROL KITS**

**MS-11D Manual Focus/Servo Zoom**  
For use with RM/ZM type lenses.

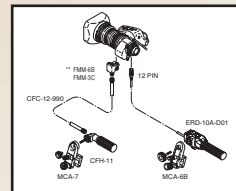

**SS-11D Servo Focus/Servo Zoom**  
For use with RM/ZM type lenses.

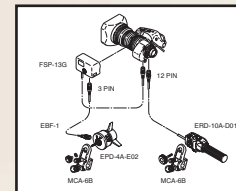

**SS-13D Servo Focus/Servo Zoom**  
For use with RD/ZD type lenses.

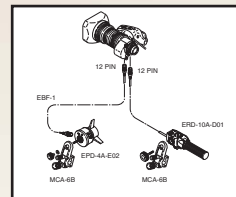

**SS-14S Servo Focus/Servo Zoom**  
For use with RD/ZD type lenses.

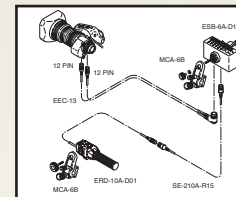

**STANDARD REAR CONTROL KITS**

**MS-11 Manual Focus/Servo Zoom**

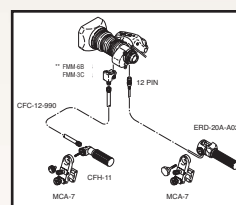

**SS-11 Servo Focus/Servo Zoom**  
Not available on HA42x, HA36x and A36x

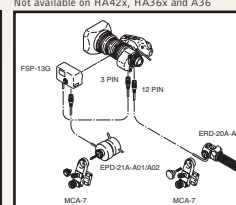

**SS-13A Servo Focus/Servo Zoom**  
For use with ERD type lenses.

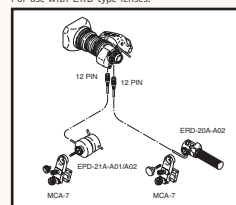

**MM-11 Manual Focus/Manual Zoom**  
Not available on HA42x, HA36x and A36x

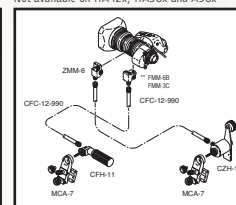

\*Specify camera type  
\*\*FMM-3C for use on HA36x, HA42x and HA25x

**MOUNTING SYSTEM**

Fujinon has replaced the "cone" shaped mounting system with the "tooth" system. The cone type may still be ordered as a special order.



Note: ERD-20A-A02 (F) and EPD-20A-A02 (L) replace the ERD-T22 and EPD-2CA.

For Sales Contact Information go to **www.Fujinon.com**