

LanParte

USER MANUAL

Contact us for further questions



www.lanparte.com



LA3D manual

Official retailer: www.xanaco.com

HONGKONG LANPARTE TECHNOLOGY LIMITED

Email: info@lanparte.com

Tel: +86-0769-81889368

Fax: +86-0769-85841828

ADD: NO.39, 2nd Xin'an road,

Changan Town, Dongguan, Guangdong, China

LanParte

DETACHABLE WIRED CONTROL GIMBAL

3-Axis Handheld Gimbal for GoPro and Sports Camera

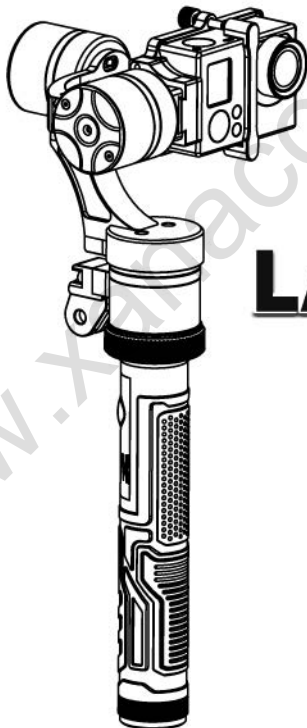

LA3D

www.xtraco.com

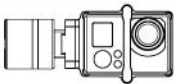

Attention !

Make sure to install GoPro before connecting power

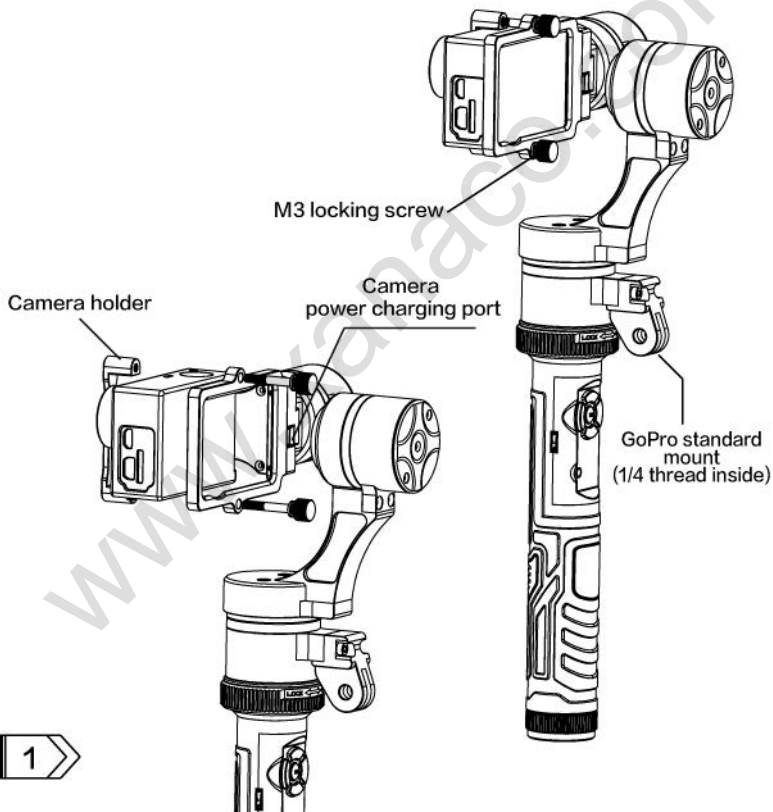

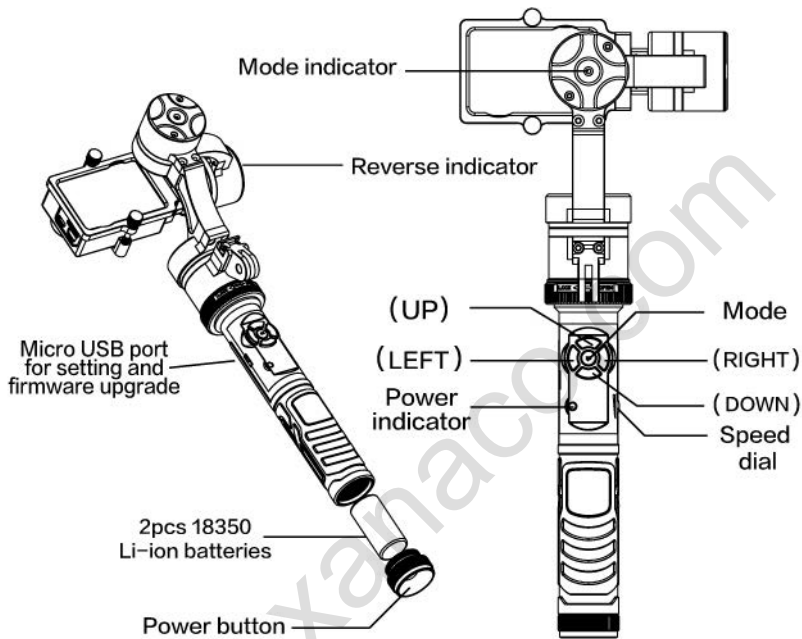

2 Compatible With

GoPro 3, GoPro 4, GoPro Session, SJCAM, XIAOMI, Sony HD-AS20, AS200V, AS30V, AS100V, HDR-AZ1, FDR-X1000V etc.

(Some cameras need to buy other accessories)

3 Package Content

Serial No.	Product Name	QTY
①	3-Axis handheld gimbal platform	x1
②	Gimbal handle	x1
③	18350 Li-ion battery	x2
④	Battery extender	x1
⑤	Detachable control cable(1.2m □ 1.5m □)	x1
⑥	Micro USB cable (For camera powering)	x1
⑦	Micro USB cable (For battery charging)	x1
⑧	Battery charger	x1

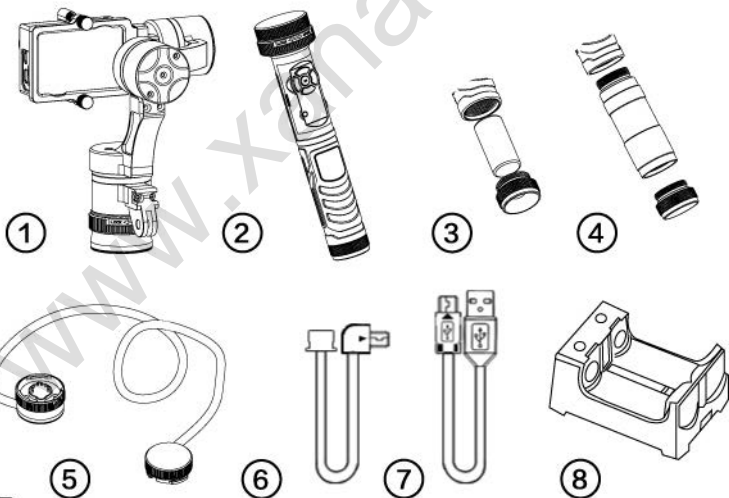

4 Operation

1. Standby mode : Press the power button to enter the standby mode. When in standby mode the signal light will turn blue and blink at interval.
2. Operating Mode: To activate operating mode press "**Mode**" for 3 seconds. To go back to standby mode press "**Mode**" again for 3 seconds.
3. Reverse mode : In standby mode press "**RIGHT**" button for 5 seconds. Flashing red light indicates reverse mode is activated.
4. Reset unit : In standby mode press "**DOWN**" button for 5 seconds, a red light blinks and all settings are restored to factory default.
5. Sensor calibration : In standby mode press "**LEFT**" button for 5 seconds and a green light starts blinking. Once the calibration is done the green light turns to red.*

Balance the platform before calibration.

5 Power Display

Power Indicator Status	Indicator Status
75%–100%	Blink 4 times
50%–75%	Blink 3 times
25%–50%	Blink 2 times
Below 25%	Keep flashing

Note : For better performance change the battery when the power is below 25% as it might affect the stability of the platform.

▶▶ Rotation Angles

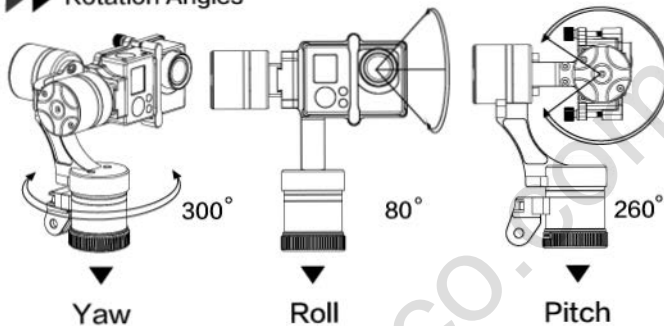

▶▶ Size

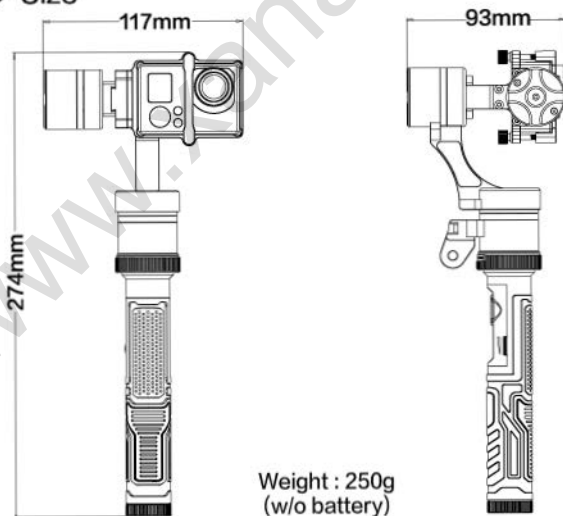

Weight : 250g
(w/o battery)

7 Mode Switching

Operating Mode	Activating By	Mode Indicator	Locking axis	Control Buttons
Following mode	Press once	Green	Roll	LEFT and RIGHT adjust roll axis
Semi-following mode	Press twice in less than 1 sec	Red	Pitch & Roll	UP and DOWN adjust pitch axis
Locking mode	Press three in less than 1 sec	Blue	Pitch Roll & Yaw	UP and DOWN adjust pitch axis, LEFT and RIGHT adjust yaw axis

* Use rotor speed dial to adjust all three rotors' speed.

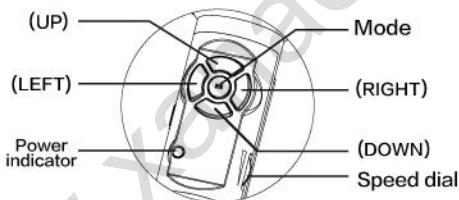

Operating mode and Axis atatus

Mode \ Axis	Pitch	Roll	Yaw
Following mode	Following	Locked	Following
Semi-following mode	Locked	Locked	Following
Locking mode	Locked	Locked	Locked

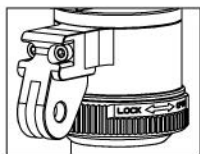

Turn counter clockwise to open

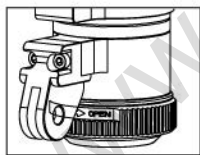

Turn clockwise to lock

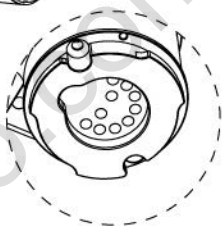
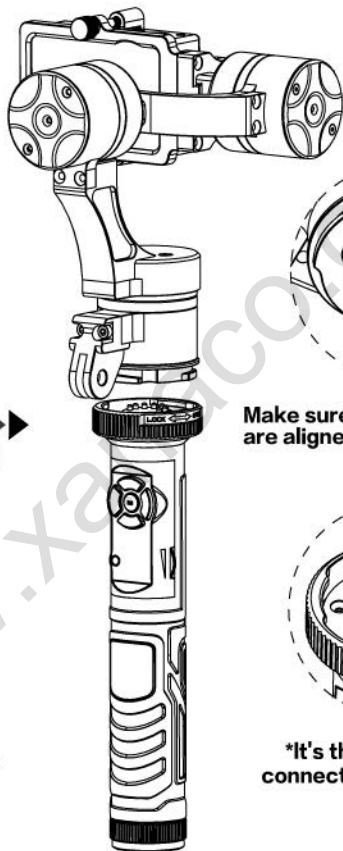

Make sure three white points are aligned while connecting.

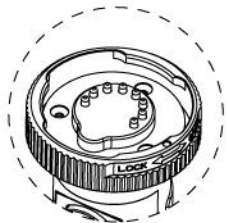

*It's the same way to connect the control cable

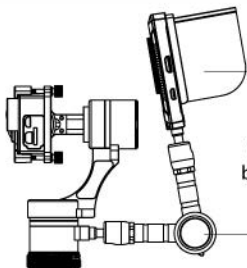

GP43H
4.3" monitor

Take down GoPro amount,
the 1/4" standard thread can
be connected with Magic arm
and Monitor.



MA-04
Magic Arm

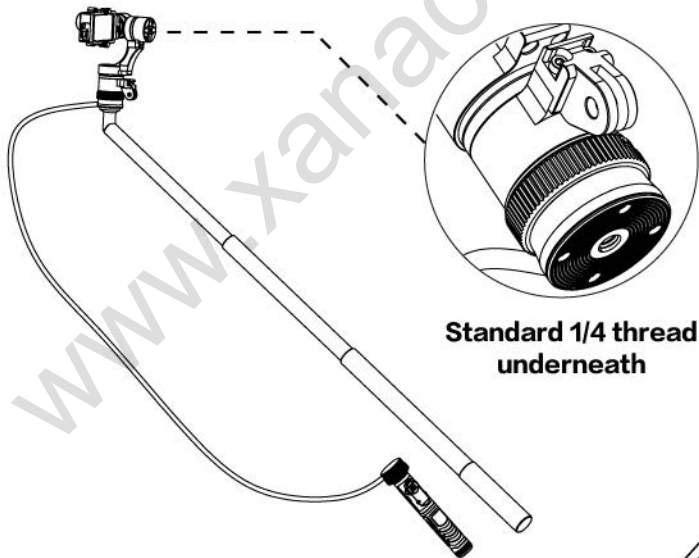

Standard 1/4 thread
underneath

10 Battery Instructions

Please note that the nominal voltage of the LA3D gimbal is 7.4V.

- Each 18350 & 18650 battery is 3.7V. Therefore, the gimbal **MUST** operate on a maximum of **TWO** batteries.
- Batteries must be combined as per below scenarios:

Scenario 1:



$$3.7V + 3.7V = 7.4V \text{ OK}$$

Scenario 2:



$$3.7V = 3.7V \text{ NOT OK!!}$$

Scenario 3:
(with extender tube)

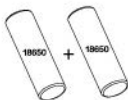

$$3.7V + 3.7V = 7.4V \text{ OK}$$

Scenario 4:
(with extender tube)



$$3.7V + 3.7V + 7.4V = 11.1V \text{ NOT OK!!}$$

11 Battery Extender

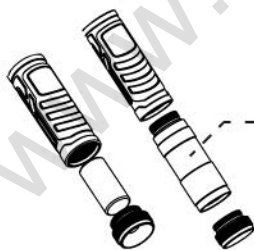

Battery extension tube

Extending the tube to install
2pcs 18650 batteries.

12 Battery and Charger

▶ Rechargeable battery

Model : 18350 Li-ion battery
Capacity : 900mAh
Charging time : 3h

▶ Li-ion battery charger

Input : DC 5V/800mAh
Output : DC 4.2V/400mAh x 2

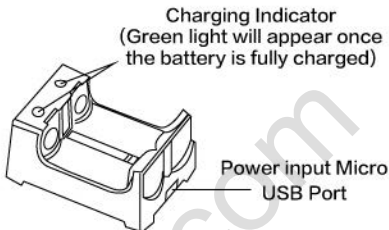

***Note :18350 battery charger can be charged by using one of the following**

- (a)Power Bank
- (b)A PC with USB port
- (c)Smartphone Charger

13 Parameter

▶▶ Item	▶▶ Parameter
Operating voltage	6.5V - 12.6V
Operating current	Standard 120mA
Pitch angle	$\pm 130^\circ$
Roll angle	$\pm 40^\circ$
Yaw angle	$\pm 150^\circ$
Battery operating time	Standard 2h
Operating Temperature	$-10^\circ \sim 40^\circ$
Net weight	345g(w/o battery and camera)
Product Dimension	274 * 117 * 93(mm)
Package Dimension	21 * 17 * 18(cm)

LanParte

USER MANUAL

Contact us for further questions



www.lanparte.com



LA3D manual

Official retailer: www.xanaco.com

HONGKONG LANPARTE TECHNOLOGY LIMITED

Email: info@lanparte.com

Tel: +86-0769-81889368

Fax: +86-0769-85841828

ADD: NO.39, 2nd Xin'an road,

Changan Town, Dongguan, Guangdong, China