



QUICK START  
**GUIDE**

用户手册

*SLYPOD* 

The SLYPOD logo graphic consists of two horizontal lines: a shorter grey line above a longer red line.

## CONTENTS

EN.....	1
CH.....	7

### **Battery and Charging**

The MOZA Slypod comes with a built-in lithium battery. When charging for the first time, please fully charge the Slypod to activate the battery. Solid red indicates the Slypod is under charging, solid blue indicates the charging is completed. With a Type-C interface, the Slypod is able to be charged by a mobile phone charger or external power bank. It will automatically stop charging when the battery is full.

Note:

1. It's recommended to use the original charging cable provided in the package!
2. Do not overcharge or over-discharge the battery, otherwise the battery cell will be damaged.
3. If the battery is idle for a long time, please recharge and discharge it every 3 months to keep it active.

## MOZA Slypod Overview

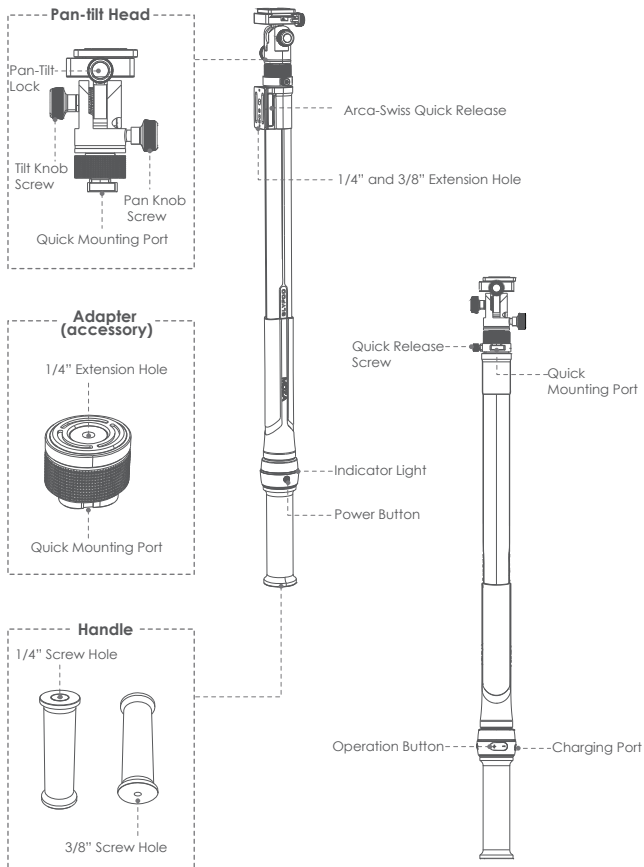

## Mounting

- **Mounting the handle**

Align the 1/4" screw hole on the handle with the 1/4" screw on the bottom of the pole, turn the handle clockwise to tighten it.

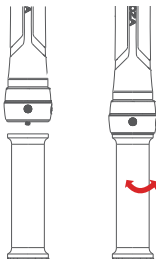

- **Mounting the pan-tilt head**

Slide the pan-tilt head into the groove at the top of the pole, make part 1 and part 2 fully fit. Turn the screw ring 3 clockwise to secure the head onto the pole. Loosen the screw ring 3, then turn the knob screw 4 anticlockwise to detach the head from the pole. After the P&T head is detached, reset the quick release knob.

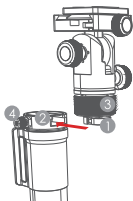

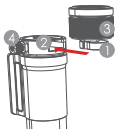

- **(Mounting the adaptor) The same method as mounting the pan-tilt head.**



## Getting Started

Long press for 3 seconds: Power on/off

### Button Functions

	Power Button 	Device State	Elongate+ 	Shorten- 
Short press	Photo taking control via the shutter cable	Static	Start to elongate	Start to shorten
	—	Elongate	Accelerate by one gear	Decelerate by one gear
	—	Shortened	Decelerate by one gear	Accelerate by one gear
	Short press power/+/- buttons(all three buttons) at the same time: Reset			
Long press	Power on	Static	Elongate and continue to accelerate	Shorten and continue to accelerate
	—	Elongate	Accelerate Continuously	Decelerate continuously to an shortened state
	—	Shortened	Accelerate continuously to an elongate state	Accelerate Continuously
	—	—	Long press +/- button at the same time: Automatic reciprocating mode(The blue light lasts for 1s indicate a mode switch.)	
Double Press	Stop	—	—	—
Triple Press	Turn Off + Reset (Blinking red)	—	—	—

### App Download

Scan the QR code or search in the App Store to download the MOZA Master App.(Please find the QR code at the end of the Manual.)



IOS



Android

### Device Connection (Wireless)

Download the "MOZA Master" App.

Turn on the phone Bluetooth and Slympod.

Launch the "MOZA Master", select the device to connect.

Enter the operation interface after connection is completed.

## App Operation

**!** Note: It's required to activate the device according to instructions before the first operation. please download the latest version. Updates are subject to change without notice. please note the major application stores

Slide the operation point to any position, the device will move according to the sliding path.

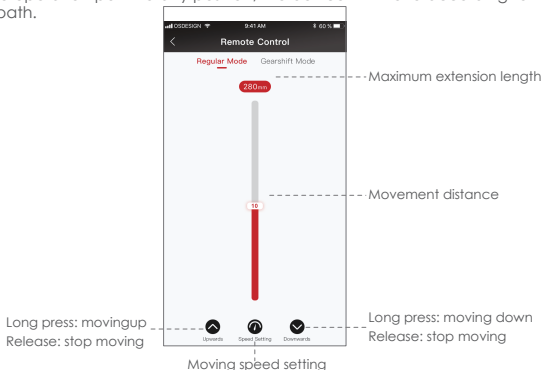

## Segmentation Mode

Select the segmentation mode, add a path (Tap to add path, 5 paths can be added in maximum), and then slide the path bar to any location. Set the running time of each path separately. Tap to start and the device will move according to the set path and speed.

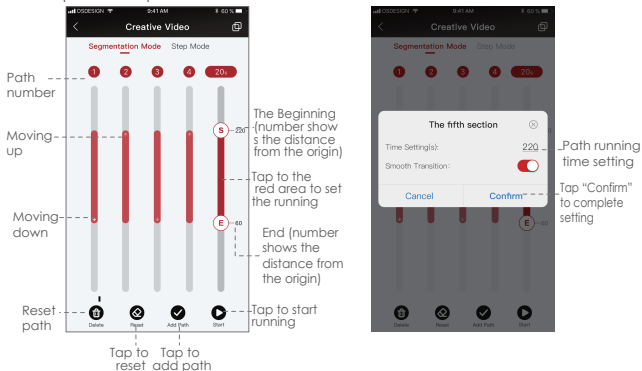

## Step Time-lapse

Select step mode to set step length, cycle, residence time and step movement time. After the setting is completed, tap "Start" and the device will move according to the set step length, speed and cycle.

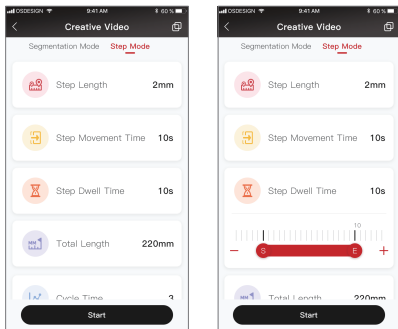

## Firmware Upgrade

In the charging state, enter the APP interface after the device is connected to the APP, and select the Firmware Upgrade to perform the upgrading. The device must be restarted after the upgrade succeeds. If the upgrade fails, the process needs to be repeated until the upgrade succeeds.

## Status Indicator

Charging	Solid red
Charging completed	Solid blue
Power on	Solid green
Under-voltage alarm	Solid orange
Low voltage alarm	Blinking red + automatic reset & shutdown (blinking red, unable to power on while pressing the power button)
Blinking green for 1s	Start/stop running switch
Blinking blue for 1s	Testing/operating modes switch

## Charging

Uncover the rubber sleeve over the charging port, the Type-C interface is inside. The Slypod can be charged by mobile phone charger, mobile power bank, etc. It will automatically stop charging when the battery is full, please disconnect the charger then. (It is recommended to use the original charging cable provided in the package)

## Specifications

Slypod	
Size	Storage Length:522mm (grip not included)
	Expanded Length:971mm
	Max Diameter:54mm
Weight	Main Body: 745g
	PTZ Head: 287g
	Grip:278g
Payload	Vertical:9kg
	Horizontal:4Kg
Operating speed	Highest:28mm/s
	Lowest:0.15mm/s
Operating Voltage	8.5v - 12.6v
Battery Life	120min
Working Temperature	-10℃ - 50℃
Communication Interface	Bluetooth
	2.4G
	Type-C
Battery Model	Lithium ion Battery
Battery Capacity	600mA/h
Battery Voltage	11.1V
Charging Port	Type-C USB
Charging Voltage	5V
Charging Time	90min

### **电池及充电说明**

Slypod使用内置锂电池，首次充电使用时，请先给Slypod充满电以激活电池，保证产品顺利使用。红灯常亮显示设备充电中，蓝灯常亮显示充电完成Slypod使用Type-C接口，手机充电器、移动电源等都可以给Slypod充电，电池充满后将停止充电。

- 1.使用Slypod过程中，请使用包装内提供的原装充电线！
- 2.切勿过充、过放电池，否则将对电芯造成损害；
- 3.若长期闲置电池，请每隔3个月左右重新充放电一次以保持电池活性。

# 认识MOZA Slypod

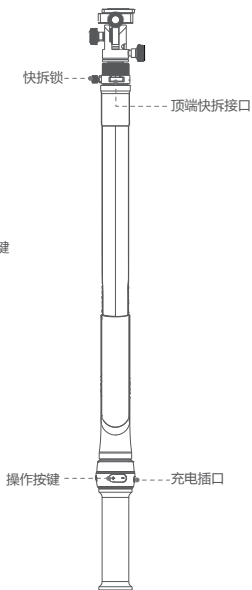
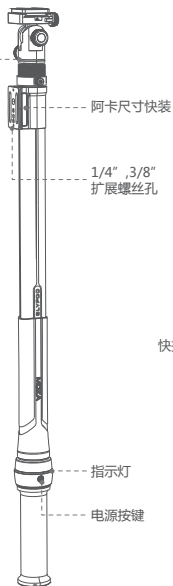
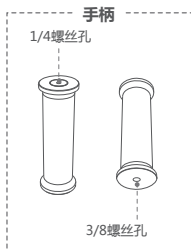
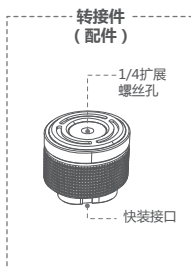
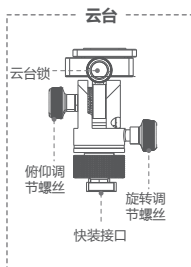

## 组装

### • 手柄与主机部分

将手柄上1/4螺丝孔对准主机1/4螺丝。顺时针旋转手柄直至扭紧，完成手柄与主机部分组装。

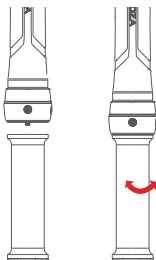

### • 主机与云台部分

将云台底端快装接口1推入主机顶端快拆接口2，两者连接后，顺时针旋转锁紧旋钮3，将主机与云台两者固定连接；逆时针旋转锁紧旋钮3，再逆时针旋转松开快拆锁旋钮4，则将主机与云台两者分离。云台拆卸后，复位快拆锁旋钮。

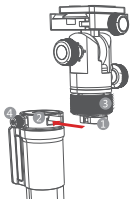

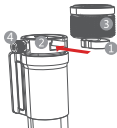

### • (转接件组装)方法与云台组装相同



## 开机使用

长按3S：开机/关机

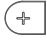
### 操作说明

	电源 	设备状态	伸长+ 	缩短- 
单击	连接快门线后 控制拍照	静止状态	启动伸长	启动缩短
	—	伸长状态	加速一档	减速一档
	—	缩短状态	减速一档	加速一档
	同时单击“电源、+、-”三键归零自校准（白灯闪烁）			
长按	开机	静止状态	启动伸长并持续加速	启动缩短并持续加速
	—	伸长状态	持续加速	持续减速至缩短最大速度
	—	缩短状态	持续加速至缩短 最大速度	持续加速
	—	—	+ -同时长按进入自动往复模式 (蓝灯亮1S表示模式切换成功)	
双击	立即停止	—	—	—
三击	关机+立即复位 (红灯闪烁)	—	—	—

### APP下载

您可以直接扫描二维码下载“MOZA Master”，也可以直接在手机应用商店中搜索“MOZA Master”进行下载



IOS



Android

### 连接设备（无线连接）

下载并安装“MOZA Master”APP

打开手机蓝牙打开设备电源

打开MOZA Master选择要连接的产品，点击连接，完成连接，连接成功后选择产品，进入该设备的操作界面。

## APP操作方法介绍

**注意：**首次连接需根据引导流程进行产品激活。请以最新版本APP为准；如有更新，恕不另行通知，请关注各大应用商城

滑动红色操作点从起点至任意位置，设备会跟随滑动

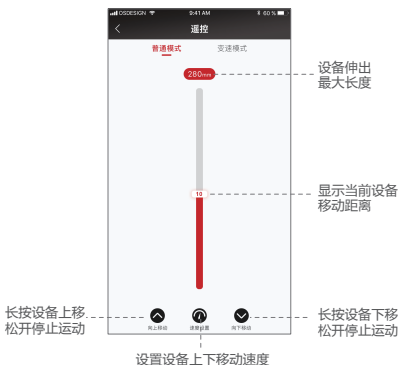

## 分段变成控制

选择分段模式，添加路径(点击添加路径最多可添加5段路径)后，滑动路径条至任意点。分别设置每段路径的运行时间。点击运行，设备将按照设置的路径方向和速度进行移动。

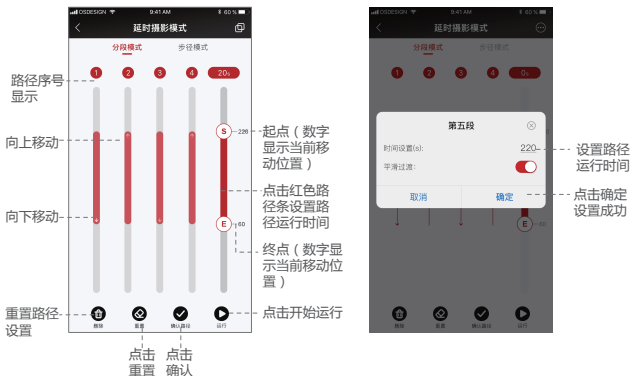

## 步进延时摄影

选择步进模式，设置步进长度，循环周期，停留时间与步进运动时间。设置完成，点击开始，设备将按照所设置的步进长度、速度与周期进行步进移动。



## 固件升级

在充电状态下，设备连接APP后进入产品APP界面，选择固件升级，即可进行固件升级。固件升级成功后须重启设备。如升级失败则需重复升级过程，直至升级成功。

## 灯光定义

充电中：	红灯常亮
充电完成：	蓝灯常亮
开机：	绿灯常亮
欠压报警：	橙黄色灯亮
低压报警：	红灯闪烁+自动归位停机（按开机键红灯闪烁不开机）
绿灯闪烁1s：	运行开关切换
蓝灯闪烁1s：	测试模式和运行模式切换

## 设备充电

打开充电插口胶套外壳，内部是Type-C接口，手机充电器、移动电源等都可以给Slypod充电，电池在充满后将停止充电，请断开充电器。（建议使用包装内提供的原装充电线）

## 规格参数

Slypod	
尺寸	收纳长度：522mm (不含手柄)
	展开长度：971mm
	最大直径：54mm
重量	主机：745g
	云台：287g
	手柄：278g
负载能力	纵向：9kg
	横向：4Kg
运行速度	最快：28mm/s
	最慢：0.15mm/s
工作电压	8.5v- 12.6v
续航时间	120min
工作环境温度	-10°C - 50°C
通信接口	蓝牙
	2.4G
	Type-C
电池类型	锂离子电池
电池容量	600mA/h
电池电压	11.1V
充电接口	Type-C USB
充电电压	5V
充电时间	90min

## 产品保修卡

产品型号		购买日期	
姓名		电话	
地址			

经销商信息 ( 签章 )

### 产品保修条例

#### **保修期**

自购机日起, Slypod主体保修12个月;电机、智能电池保修3个月。设备外壳、说明书、USB线材、包装等不在"一年免费保修服务"范围内,您可以选择有偿服务。

#### **七日内免费退货**

自购机日起7日内,根据国家最新三包规定,您可以选择退货(按票面金额一次性退清货款)、换货(更换同型号同规格的产品)或修理。

#### **八至十五日免费换货或修理**

自购机日起第8日至第15日内,主机出现性能故障,并经特约维修中心检测,确认非人为损坏的本身质量问题,您可以选择换货(更换同型号、同规格产品)或修理;但是更换的范围,只限于产品主机,其他配件无质量问题,不能更换;购买者在以下条件下不享受免费保修服务,您可以选择有偿服务。

1. 超过三包有效期的 ;
2. 无三包凭证及有效发货票的,但能够证明该产品在三包有效期内的除外 ;
3. 包修凭证上的型号与修理产品型号不符或者涂改的 ;
4. 非本公司特约维修人员拆动造成损坏的 ;
5. 因不可抗力力造成损坏的 ;
6. 未按产品使用说明书要求使用、维护、保养而造成损坏的。

## Contacts/联络卡



Official Website  
官网



Sina Weibo  
新浪微博



WeChat  
微信



Instagram



Twitter



Facebook



YouTube

## Tutorial/教程



Firmware Upgrade  
and Calibration  
YouTube QR  
固件升级及校准教程  
“YouTube二维码”



Firmware Upgrade  
and Calibration  
WeChat QR  
固件升级及校准教  
程 “微信二维码”

# 合格证

出厂日期: \_\_\_\_\_

质检员: \_\_\_\_\_

**GUDSEN**

INVENTED FOR VIDEO  
Gudsen Technology Co., Ltd  
Web: [www.gudsen.com](http://www.gudsen.com)