

VF Panel Section

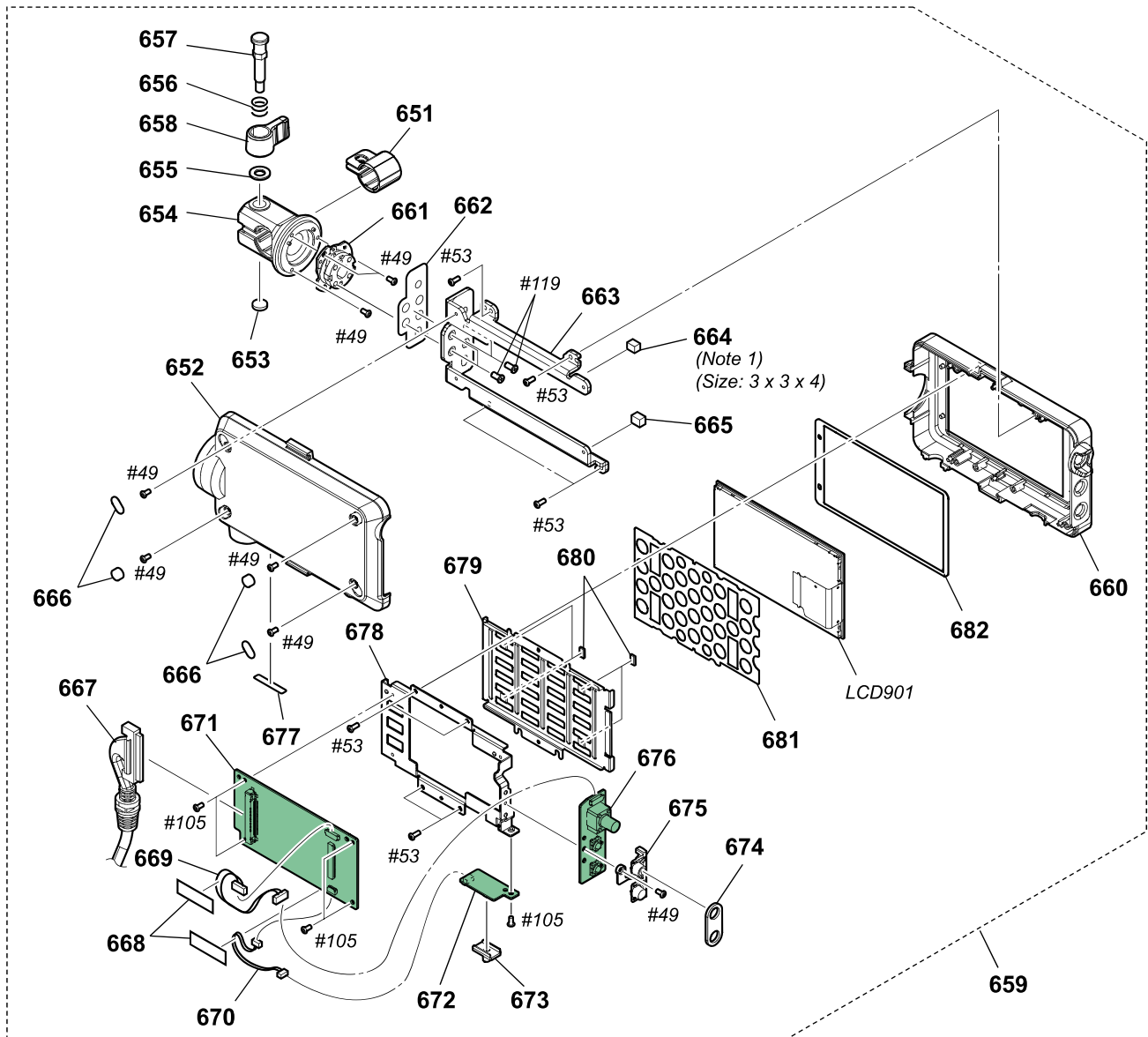

Ref. No. or Q'ty	Part No.	SP Description	Ref. No. or Q'ty	Part No.	SP Description
651	4-684-615-01	BUSHING (S), VF SLIDE	670	1-970-534-11	SUB HARNESS PM-KY735
652	4-547-073-01	P CABINET	671	A-2170-429-A	PM-1007 BOARD, COMPLETE
653	4-694-075-01	SHEET, VF CLAMP	672	A-2170-435-A	KY-1018 BOARD, COMPLETE
654	4-684-616-01	CLAMP (956), VF	673	4-458-703-02	KNOB (VF), SWITCH
655	7-688-005-02	W 5, SMALL	674	4-547-081-01	CUSHION, DROP PROTECTION
656	4-691-179-01	SPRING (956), ROD LOCK	675	4-547-075-01	SWITCH, PUSH
657	4-684-598-01	SCREW (956), CLAMP LOCK	676	A-2170-434-A	KY-1017 BOARD, COMPLETE
658	4-684-597-01	LEVER (956), CLAMP LOCK	677	4-544-784-01	LABEL (MADE IN CHINA)
659	A-2170-652-A	PANEL BLOCK ASSY, VF	678	4-547-074-01	P SUBFRAME
660	4-547-072-01	P BEZEL	679	4-547-078-01	LCD RETAINER
661	X-2318-442-2	HINGE ASSY	680	4-535-706-01	ESD GASKET
662	4-547-082-01	INSULATING SHEET (P)	681	4-547-080-01	LCD CUSHION
663	4-547-076-01	FRAME, HINGE	682	4-547-079-01	CUSHION, PANEL
664	4-564-261-01	GASKET (3X3 (20)), SOFT	LCD901	A-2070-347-A	SERVICE, LCD BLOCK ASSY
665	4-564-635-01	GASKET (5.5X5 (7)), SOFT	#49	2-630-005-31	SCREW (M2), NEW TRUSTER, P2
666	4-547-083-01	SHEET, BLIND	#53	3-080-206-21	SCREW, TAPPING, P2
667	1-848-672-13	CABLE, CONNECTION	#105	2-891-494-31	SCREW (M2), NEW TRUSTER, P2
668	4-431-734-01	TAPE AS	#119	7-627-556-58	SCREW +P 2.6X5
669	1-970-515-11	SUB HARNESS PM-KY734			