

ECARTONIE

PROFESSIONAL CAMERA SUPPORT

P40



USER'S MANUAL
&
MAINTENANCE



Thank you for choosing the **P40** Pedestal manufactured by **CARTONI S.p.A.**

The **P40** is designed and built using state-of-the-art technologies and procedures in order to guarantee maximum reliability over time, as well as total safety for its users.



! In order to properly and safely use the **P40** Pedestal read this manual very carefully and follow the instructions.

! All back-up material, and this manual in particular, should be stored in a safe place for future reference.

! This publication may not be reproduced in full or in part, or memorised, transmitted or translated into any common or computer language, in any form or by any electronic, mechanical, magnetic, optical, chemical, manual or other means without the express authorization in writing of **CARTONI S.p.A.**

! **CARTONI S.p.A.** holds the right to revise or change this publication without any prior advice to any person or organization.

2

DISCLAIMER

CARTONI SpA certifies that the information contained in this manual is correct at the time of printing. **CARTONI** SpA reserves the right to update or change any specification, design and/or functionality of the product and the relevant information at any time and without notification. Updates in the documentation will be incorporated in the new release of the same. For the updated version please consult the latest release on our website www.cartoni.com.

DECLARATION OF CONFORMITY

CARTONI SpA declares that this product has been manufactured in accordance with standards ISO 9001:2015 and complies with the EC Directive 2001/95/CE.

1. INTRODUCTION	4
1.1 PROPER USE	4
1.2 WARRANTY	5
1.3 AUTHORIZED PERSONNEL	5
1.4 REGULATORY INFORMATION	5
1.5 DOCUMENTATION	7
2. TECHNICAL SPECIFICATIONS	8
2.1 SPECIFICATIONS	10
2.2 COMPATIBLE EQUIPMENT	11
2.3 USAGE	12
3. INSTALLATION AND SETTINGS	12
3.1 SETTING THE PEDESTAL	15
3.2 MOUNTING THE CAMERA	19
3.3 PRESSURIZING THE PEDESTAL AND BALANCING THE LOAD	19
4. USING THE PEDESTAL	20
4.1 CABLE GUARDS	21
4.2 TRAVELLING	21
4.3 SAFETY PRECAUTIONS	22
5. DISASSEMBLING AND STORAGE	24
6. SERVICE	26
6.1 ROUTINE MAINTENANCE	26
6.2 EXTRA MAINTENANCE AND SPARE PARTS	26
6.3 WHEEL EXCHANGE RECOMMENDATION	27
6.4 ENVIRONMENTAL PROVISIONS	27

1. INTRODUCTION

The correct and safe use of this Pedestal is only guaranteed if it is used in accordance with the following manual and other documentation that accompanies the **P40** Pedestal. It is therefore essential to read all the documentation carefully and to keep it in a safe place.

Although the equipment features safety devices not all the risks inherent its improper use can be avoided.

It is necessary to always make sure that all operators have completely read and understood the instructions. **CARTONI S.p.A.** accepts no responsibility for damage to persons and/or property consequent to the improper use of the Pedestal.

Do not remove or deface any label, indication and warning affixed to the Pedestal.

CARTONI S.p.A. declines all responsibility for the failure to observe the standards of safety and prevention detailed in the various sections of this manual and for injuries caused due to improper use.

Any modification to the Pedestal must have prior authorization by **CARTONI S.p.A.**

All the standard maintenance operations (maintenance, repairs, cleaning and adjustments) should be carried out by competent personnel as prescribed in the manual.

4

1.1 PROPER USE

The Pedestal has been designed and built for the support and movement of a Head with Camera/lenses mounted on its horizontal and vertical axis.

In particular this manual refers to the machine specifications in section 2.



- ! It is strictly forbidden to use the Pedestal in any other way other than indicated.
- ! The components used must conform to the indications in section 2.
- ! Do not remove or deface any label, indication or warning affixed to the machine.
- ! Any modification to the Pedestal and/or its structure and/or accessories must have prior authorization by **CARTONI S.p.A.**
- ! Before using this Pedestal the manual should be read carefully. Whoever uses the machine must be well informed on the operative capacity and limits outlined in the manual.

The **P40** Pedestal is covered by a warranty against manufacturing defects for 5 years from the date of shipment (three years basic warranty + two years upon online registration to www.cartoni.com).

The warranty covers replacement of any defective part and the labour required excluding transport/duty costs.

In the case of replacement of single parts, these can be supplied free of charge by **CARTONI S.p.A.** but the owner will bear the cost of transport/duty charges for the parts.

The warranty is only valid if the Pedestal has been used properly as outlined in the manufacturer's instructions and has not been exposed to any mishandling. The warranty will be immediately invalid if modifications and/or repairs are carried out by unauthorized persons otherwise authorized by **CARTONI S.p.A.**

Components subject to wear and tear are not covered by the warranty.

The warranty is also invalidated by one of the following events:

- Failure to comply with payment conditions
- Failure to carry out appropriate maintenance
- Removal or mistreatment of marks and/or labels containing data and technical specification.

CARTONI S.p.A. accepts no responsibility for damage to the Pedestal caused by improper use or the malfunction of other equipment connected to the Camera support.

In any case, the warranty only covers Pedestal damage and/or malfunctions and does not entitle the purchaser/owner to claim any damages for loss of production time due to assumed or proven damage caused by and/or connected to the Pedestal itself.

1.3 AUTHORIZED PERSONNEL

Extraordinary maintenance and repairs to the machine can only be carried out by competent persons who are either employed, trained or authorized by **CARTONI S.p.A.** in writing.

Any information regarding repair/maintenance service stations can be obtained from **CARTONI S.p.A.**

1.4 REGULATORY INFORMATION

The design and construction of the Pedestal by **CARTONI S.p.A.** complies with the regulations listed below:

- UNI EN ISO 12100 (2010) Safety of machinery - General principles for design – Risk assessment and risk reduction
- Directive 2006/42/CE Covering the harmonization of member States' laws on machinery
- Presidential Decree 17/2010 of 27/01/2010: Regulation implementing EU directive 2006/42/CE and subsequent amendments

Additional technical standards relating to specific safety measures as the UNI EN ISO 13857:2020 concerning safety distance and the UNI EN ISO 13850:2015 concerning the emergency machine stop have been considered.



IQNet, the association of the world's first class certification bodies, is the largest provider of management System Certification in the world. IQNet is composed of more than 30 bodies and counts over 150 subsidiaries all over the globe.

CERTIFICATO N. 19714/09/S
CERTIFICATE No.

SI CERTIFICA CHE IL SISTEMA DI GESTIONE PER LA QUALITÀ DI
 IT IS HEREBY CERTIFIED THAT THE QUALITY MANAGEMENT SYSTEM OF

CARTONI S.P.A.

VIA DI PORTONACCIO, 33/B 00159 ROMA (RM) ITALIA
 NELLE SEGUENTI UNITÀ OPERATIVE / IN THE FOLLOWING OPERATIONAL UNITS

VIA DI PORTONACCIO, 33/B 00159 ROMA (RM) ITALIA

È CONFORME ALLA NORMA / IS IN COMPLIANCE WITH THE STANDARD

ISO 9001:2015

PER I SEGUENTI CAMPI DI ATTIVITÀ / FOR THE FOLLOWING FIELD(S) OF ACTIVITIES

PROGETTAZIONE, FABBRICAZIONE ED ASSISTENZA POST-VENDITA DI PRODOTTI PER LA CINEMATOGRAFIA E LA TELEVISIONE PROFESSIONALE. COMMERCIALIZZAZIONE DI PRODOTTI ED ACCESSORI IN CONCESSIONE PER LA CINEMATOGRAFIA E LA TELEVISIONE PROFESSIONALE

IAF:17
IAF:29

DESIGN, MANUFACTURE AND POST-SALE ASSISTANCE OF PROFESSIONAL BROADCAST AND FILM EQUIPMENT. MARKETING OF PROFESSIONAL BROADCAST AND FILM ACCESSORIES AND PRODUCTS AS LOCAL AGENCY/REPRESENTATIVE

La validità del presente certificato è subordinata a sorveglianza periodica annuale / semestrale ed al riesame completo del sistema di gestione con periodicità triennale

The validity of this certificate is dependent on an annual / six monthly audit and on a complete review, every three years, of the management system

L'uso e la validità del presente certificato sono soggetti al rispetto del documento RINA: Regolamento per la Certificazione di Sistemi di Gestione per la Qualità

The use and validity of this certificate are subject to compliance with the RINA document : Rules for the certification of Quality Management Systems

Prima emissione First Issue	12.06.2009	Data decisione di rinnovo Renewal decision date	24.05.2021
Data scadenza Expiry Date	02.06.2024	Data revisione Revision date	24.05.2021

Amilcare Rini

Rome Management System
Certification, Head

RINA Services S.p.A.
Via Corsica 12 - 16128 Genova Italy



www.cisq.com

CISQ è la Federazione Italiana di Organismi di Certificazione dei sistemi di gestione aziendale



SGQ N° 002 A

Membro degli Accordi di Mutuo Riconoscimento EA, IAF e ILAC

This manual is supplied with the Pedestal along with the warranty card and both must be saved for any further consultation or use.

The present manual can be downloaded from www.cartoni.com website.

In case of sale or transferring ownership of the Pedestal, the manual and warranty card must be handed over to the new operator or owner.

The Pedestal designed and built by **CARTONI S.p.A** has passed the final test performed at the factory to verify functional features, dimensional characteristics and durability.

Test results are saved by internal records and relate to:

- Serial number and date of the test
- List of compliance data to standard
- Notes, attachments, specifications, etc.



! The Pedestal cannot be used unless it has been positively tested and operators fully trained.



2. TECHNICAL SPECIFICATIONS

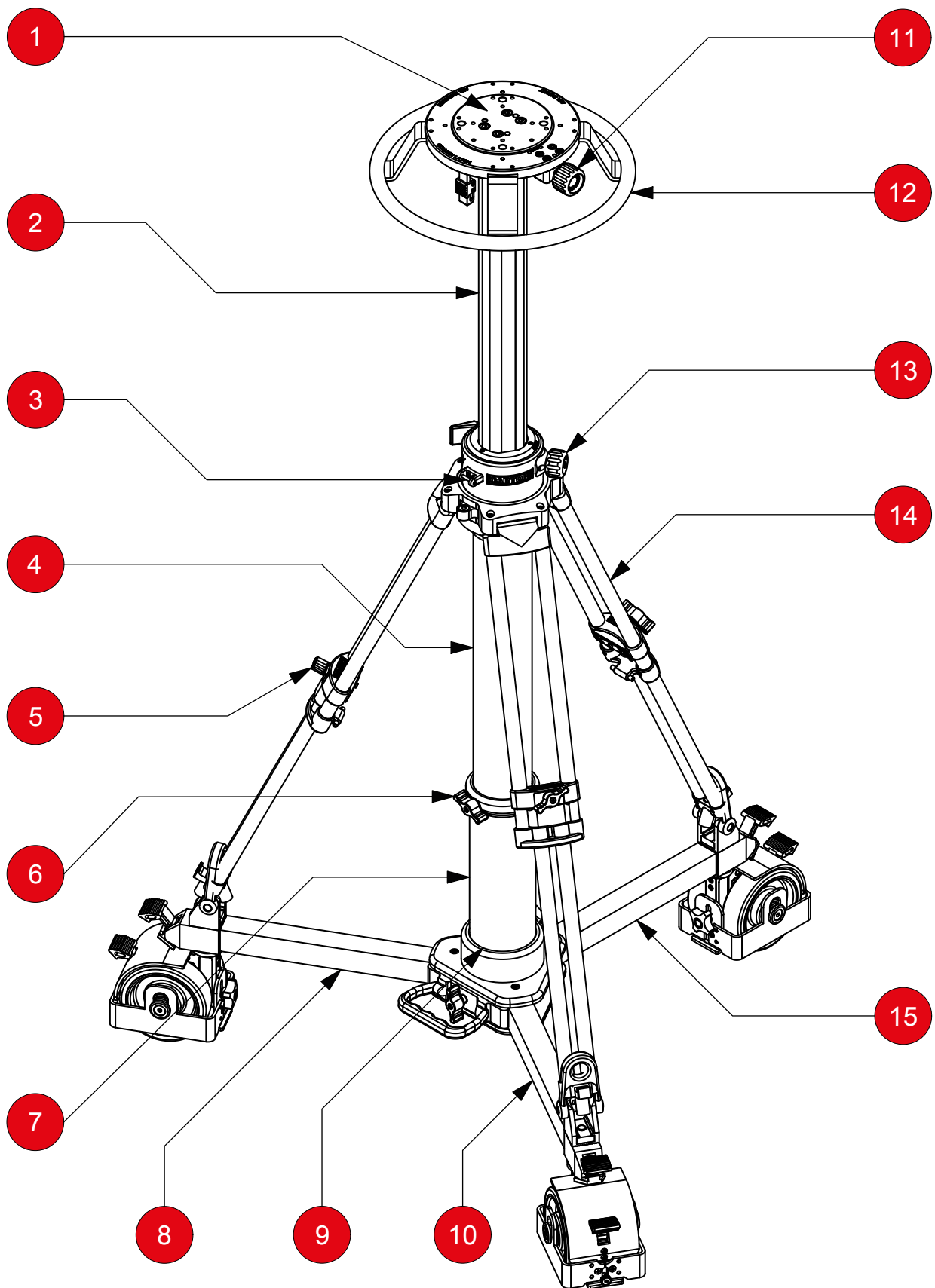

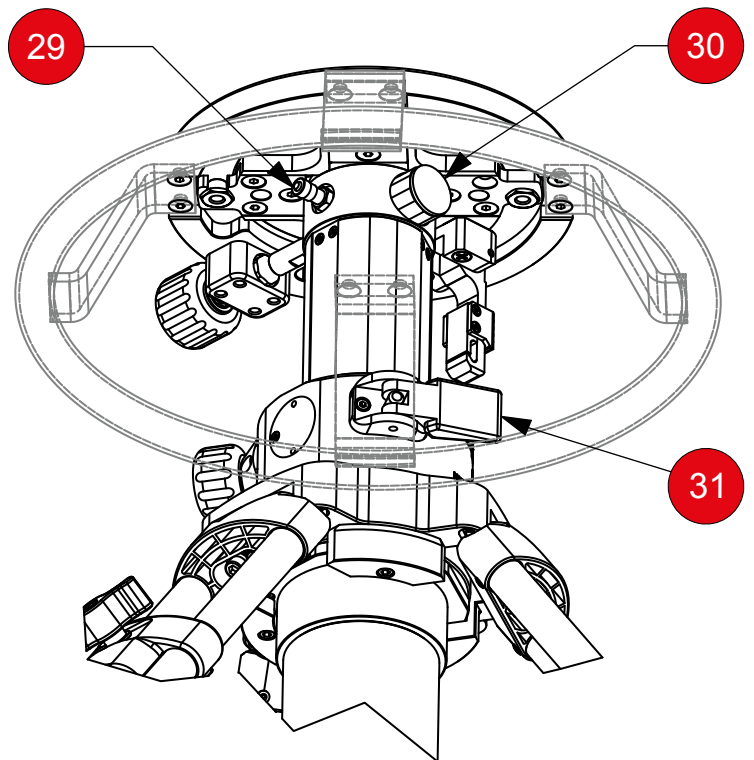
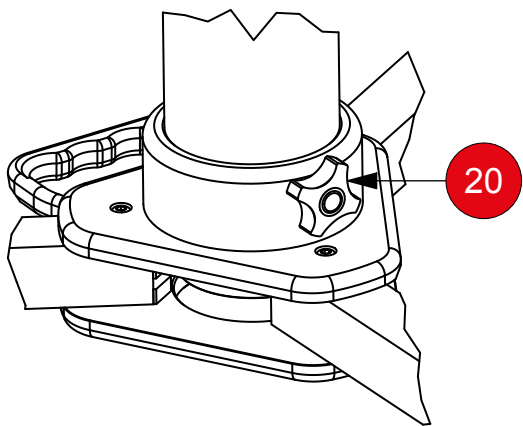
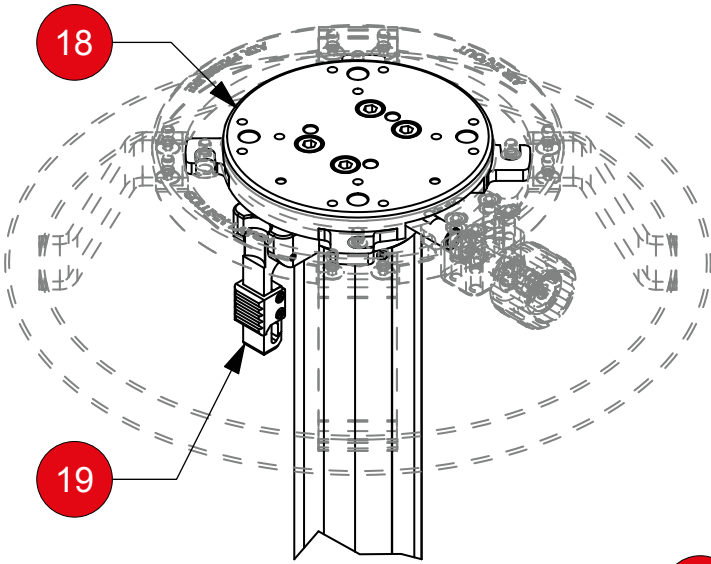
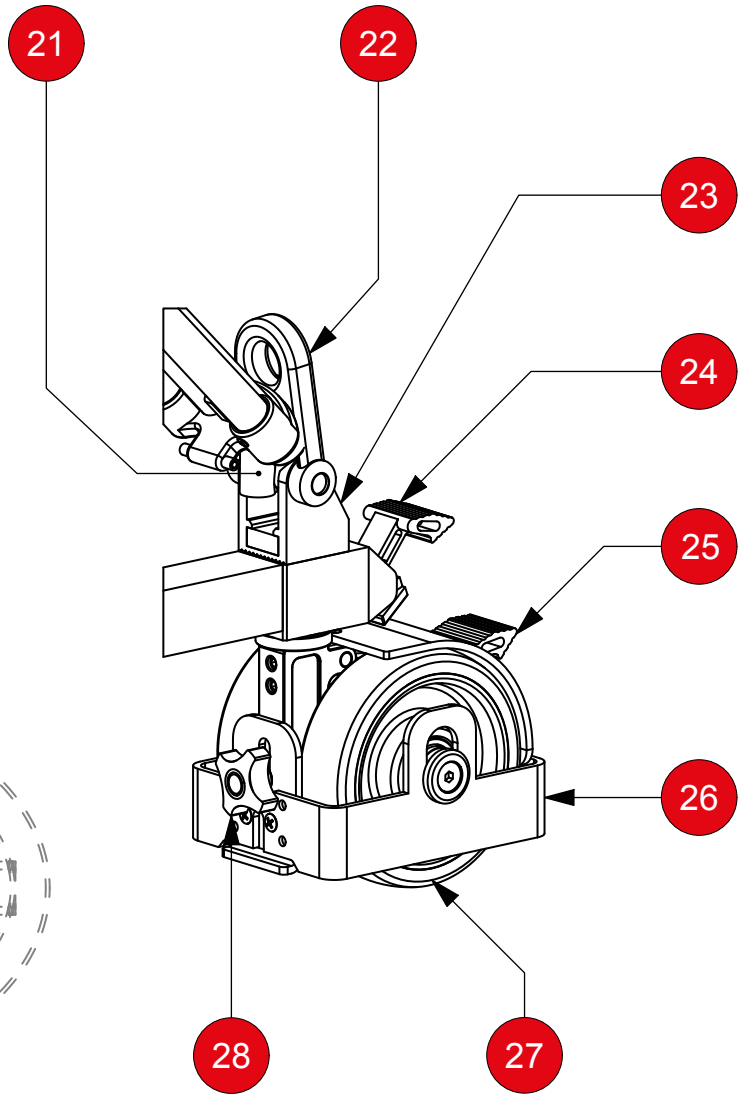
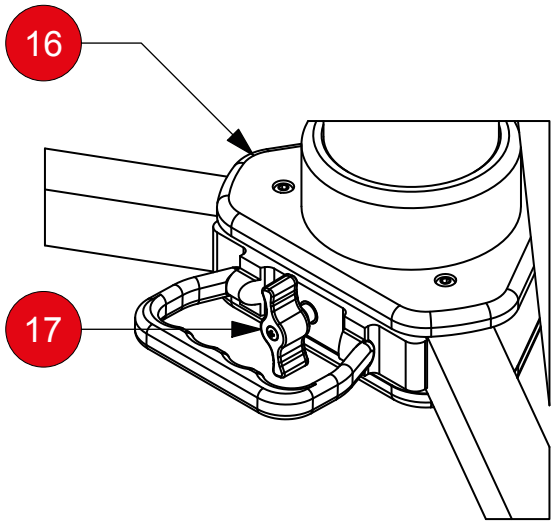

- | | | |
|--------------------------------------|-----------------------------------|-------------------------------------|
| 1 Steering wheel support | 12 Steering wheel | 23 Foot inserting seat |
| 2 Extendable pneumatic column | 13 Drag control knob | 24 Wheel position lock lever |
| 3 Safety hooking bar | 14 Tripod leg | 25 Wheel lock |
| 4 Fixed column | 15 Central skid leg | 26 Cable guard |
| 5 Tripod leg lever | 16 Skid base | 27 Studio wheel Ø125 mm |
| 6 Column lock | 17 Skid arms locking lever | 28 Cable guard knob |
| 7 Connection element | 18 4 bolt mounting plate | 29 Intake valve |
| 8 Right skid leg | 19 Safety latch | 30 Gauge G1/8 - 20 bar |
| 9 Coupling hole | 20 Skid clamp | 31 Stroke lock |
| 10 Left skid leg | 21 Tripod foot | |
| 11 Steering wheel lock knob | 22 Rubber hook | |

2.1 SPECIFICATIONS

Payload (up to)	45 Kg	99.2 lb
Column weight	13,2 Kg	29.1 lb
Skid weight	10 Kg	22.0 lb
Total weight	23,2 Kg	51.1 lb
Minimum height	71 cm	27.9 in.
Maximum height	157 cm	61.8 in.
Minimum height from ground	25 mm	0.98 in.
On-shot stroke	47 cm	18.5 in.
Doorway tracking width Min	75 cm	29.5 in.
Wheel diameter	125 mm	4.9 in.
Steering wheel diameter	360 mm	14.2 in.
Skid leg radius	41,3 cm	16.3 in.
Max working pressure	10 bar	146.9 psi
Max safety valve pressure	10,5 bar	154.3 psi
Operational temperature	-20° C / +60° C	-4° F / +140° F

2.2 COMPATIBLE EQUIPMENT

The equipment used with the **P40** Pedestal should comply with the following characteristics:

- Optimal weight (Camera + accessories + fluid Head): <40 kg;
- Maximum weight (Camera + lens/accessories + fluid Head): 45 kg;
- Weight distribution must take in consideration that the centre of gravity (CG) of the mounted elements stays well inside the rim of the wheelbase.



! The Pedestal should be only used to support the horizontal and vertical Camera movements of Cameras within the weights indicated above.

! **CARTONI S.p.A.** accepts no responsibility for malfunctions or damage to persons or equipment, gear, materials, etc. when used with equipment other than those indicated in the manual.

! **DANGER:** It is strictly forbidden to climb on the Pedestal to transport people.

Optional accessories for tilt Head mounting



Details can be found on www.cartoni.com

2.3 USAGE

The Pedestal has been designed to work in a clean, dry environment; furthermore the Pedestal must not be used in areas with fine dust or corrosive gases.



! The Pedestal is not designed to work in areas subject to atmospheric explosives, the presence of fine dust, corrosive gases, acids, corrosive agents or salt or sea salt; furthermore it is not suitable for use in presence of ionized radiation or non ionized radiation (x-rays, laser, micro-waves, ultra violet rays).

The working conditions are:

- Temperature range: -20° C / + 60° C (- 4° F/+140° F)
- Humidity: 30 - 95 % (without condensation)

If the environmental conditions are critical we advise to install an adequate air conditioning in the area to balance the humidity and temperature to acceptable levels.

The Pedestal needs no particular requirements for storage, but should be stored in a dry dust free closed place; these conditions should be ensured even during transportation.

If the storage area is dusty we advise to cover the Pedestal with a protective cover.

The Pedestal produces a very low level noise; anyway, the weighted equivalent acoustic pressure emitted by the Pedestal is below 70 dB.

3. INSTALLATION AND SETTINGS

The Pedestal is split into the following component parts for shipment:

- A** Skid base - dolly with 125 mm (4.9 in.) diameter wheels
- B** Fixed column
- C** **CARTONI** manual air-pump
- D** Removable steering wheel
- E** 4 x bolt 3/8" x 1"
- F** Allen key

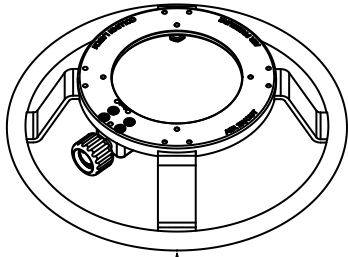

D

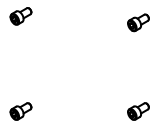
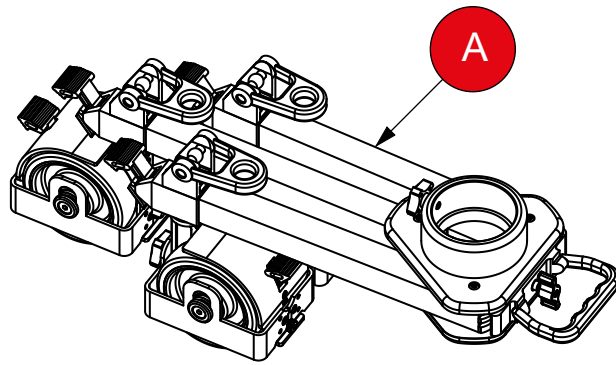
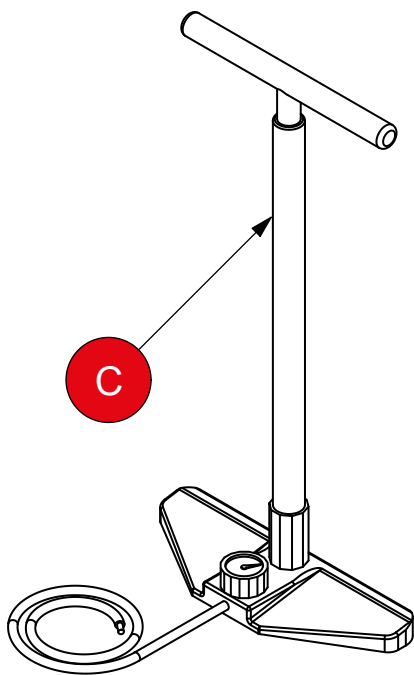
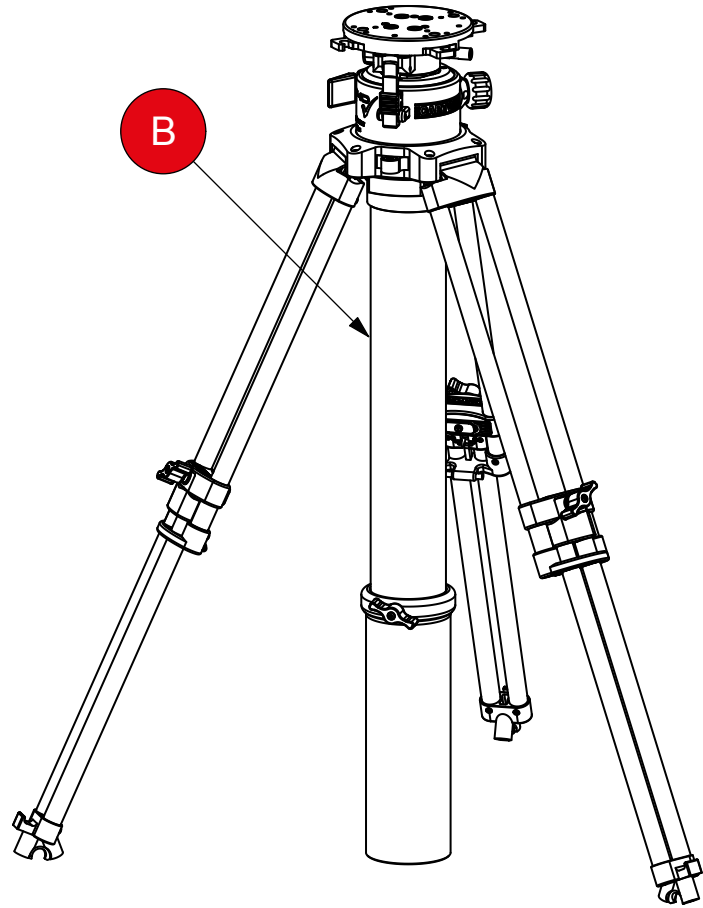

E

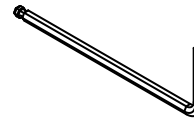

F

Prior to installation, please check the state of the packaging for its integrity on arrival, and also make sure that none of the components show signs of impact. If any such damage occurs **CARTONI S.p.A.** should be informed immediately.

If the product is to be forwarded elsewhere, it should be carefully packed and the greatest care should be taken not to damage any of the components.

The machine contains the following labeling and inscriptions:

- CE mark
- Model
- Type
- Serial number



! It is strongly advised not to remove the labels found on the Pedestal; the labels must remain well fixed, maintained and readable.

! The information found on the Pedestal labels should be given whenever assistance or changes are needed.

! The installation must be carried out by qualified personnel.

! The product must be used on smooth horizontal flooring, able to hold the Pedestal weight and guarantee its stability.

! The flooring should be such as to guarantee the stability of the Pedestal, both in movement and at rest.

3.1 SETTING THE PEDESTAL

Please assemble the Pedestal as follows:

Release the Skid arms locking lever (17) to free the Skid arms and rotate the two arms in completely opened position; then lock in place with the Skid arms locking lever (17).

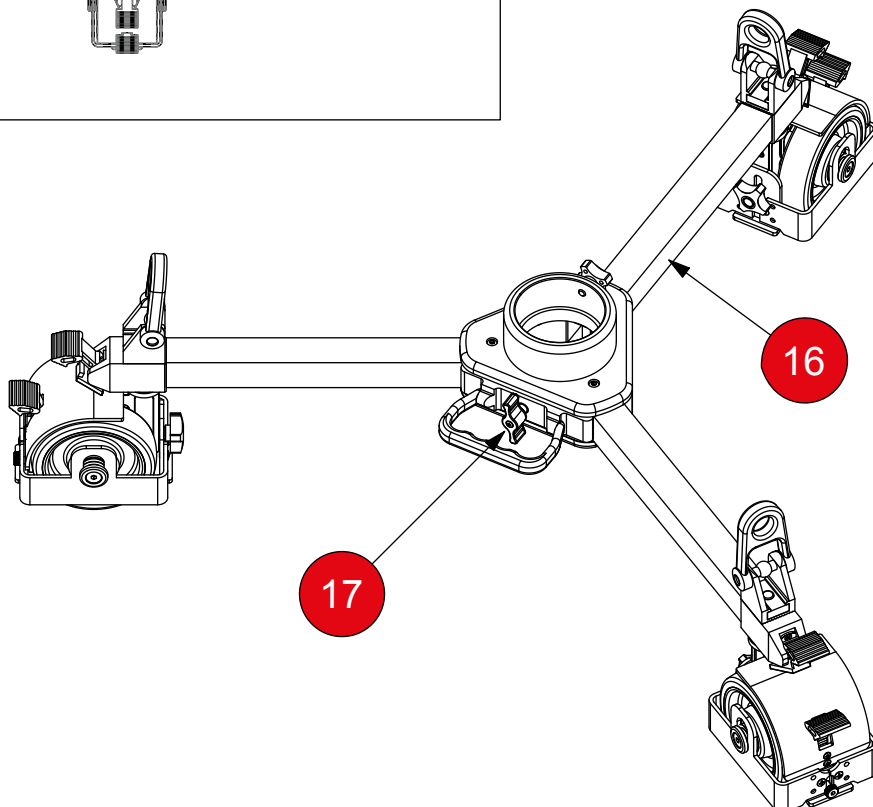
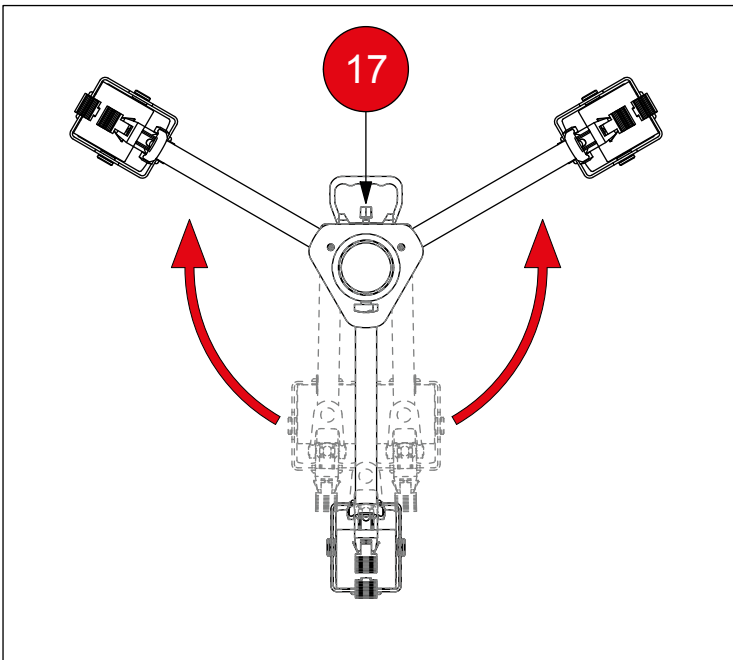
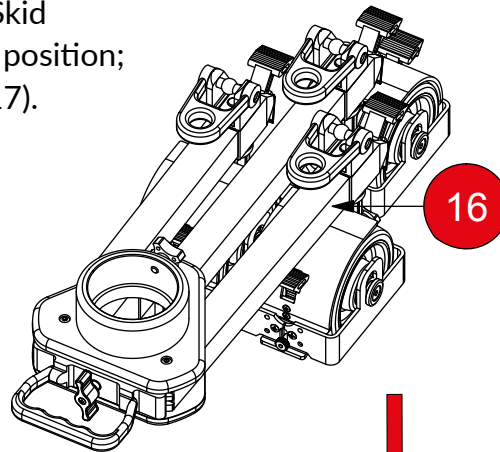

Install the column in the skid as follows:

Keep the column in vertical position and open outwards the three tripod legs (14).

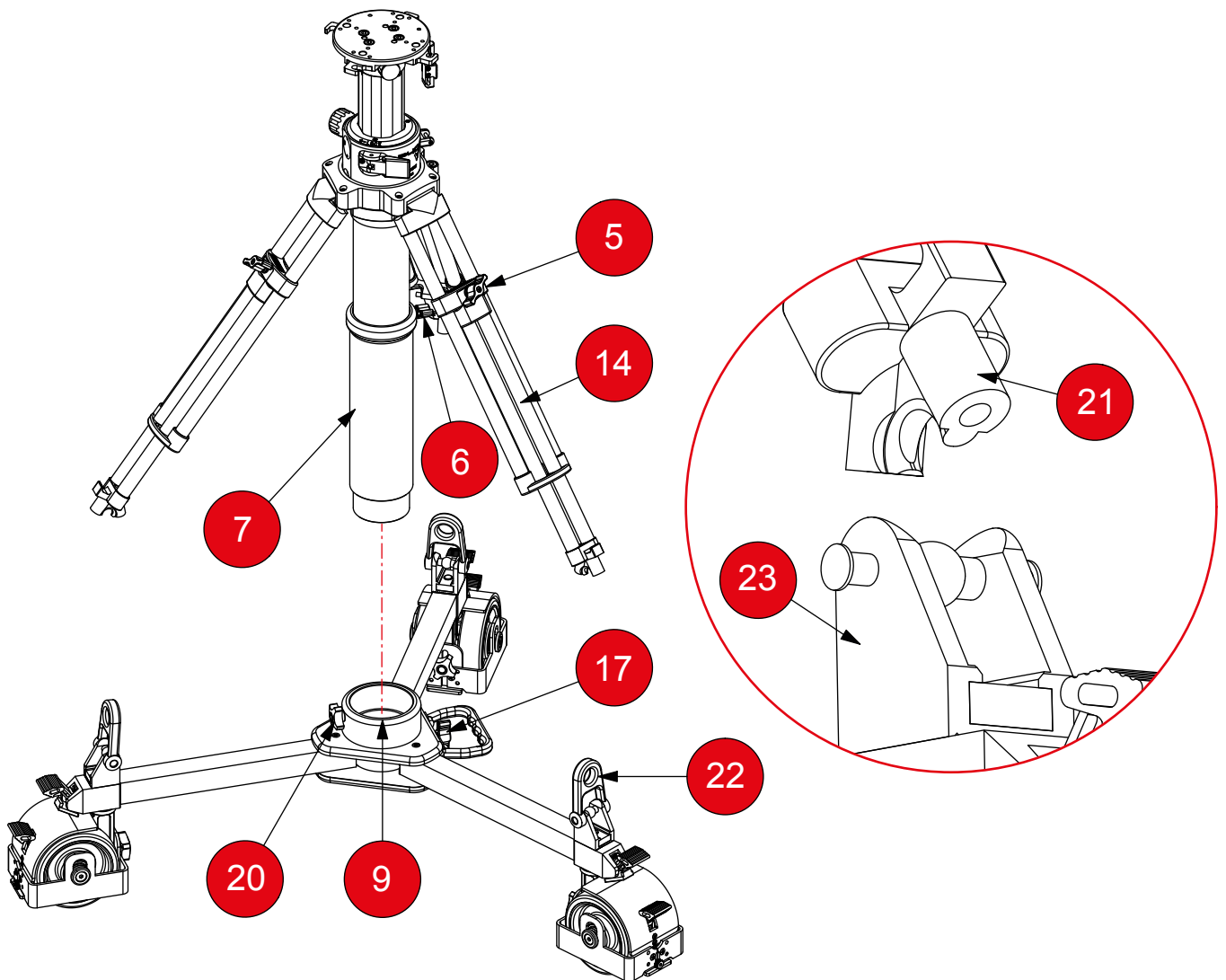

Loosen the tripod leg lever (5), extend each tripod leg (14) to its maximum length and lock with tripod leg lever (5).

Place the three tripod legs feet (21) on the foot inserting seats (23) on the skid arms, checking that the tripod legs feet (21) are perfectly coupled on the foot inserting seats (23) and push them down until feeling a click.

Secure with rubber hooks (22).

Loosen skid clamp (20) and the column lock (6), move the connection element (7) to the lowest position, inserting it with caution in the central hole of the Skid (9).

The skid arms locking lever (17) and the column lock (6) must be aligned.

Lock skid clamp (20) and the column lock (6).

Assemble the steering wheel (12) to the column as follows:

Place the steering wheel (12) on the steering wheel support (1), coupling the green mark on (12) with the red mark on (1).

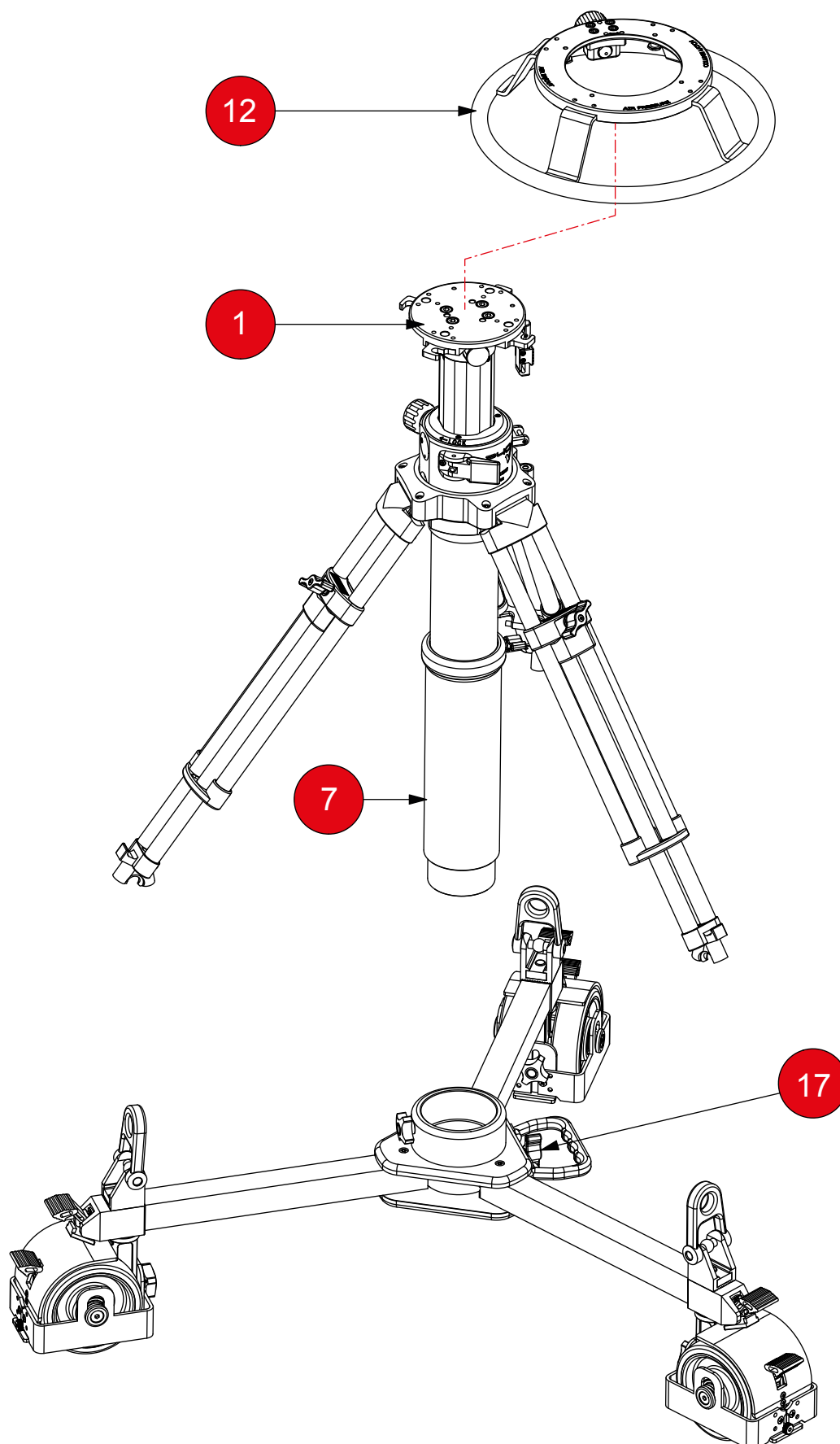

Rotate the steering wheel (12) till the red mark matches the red mark on the steering wheel support (1).

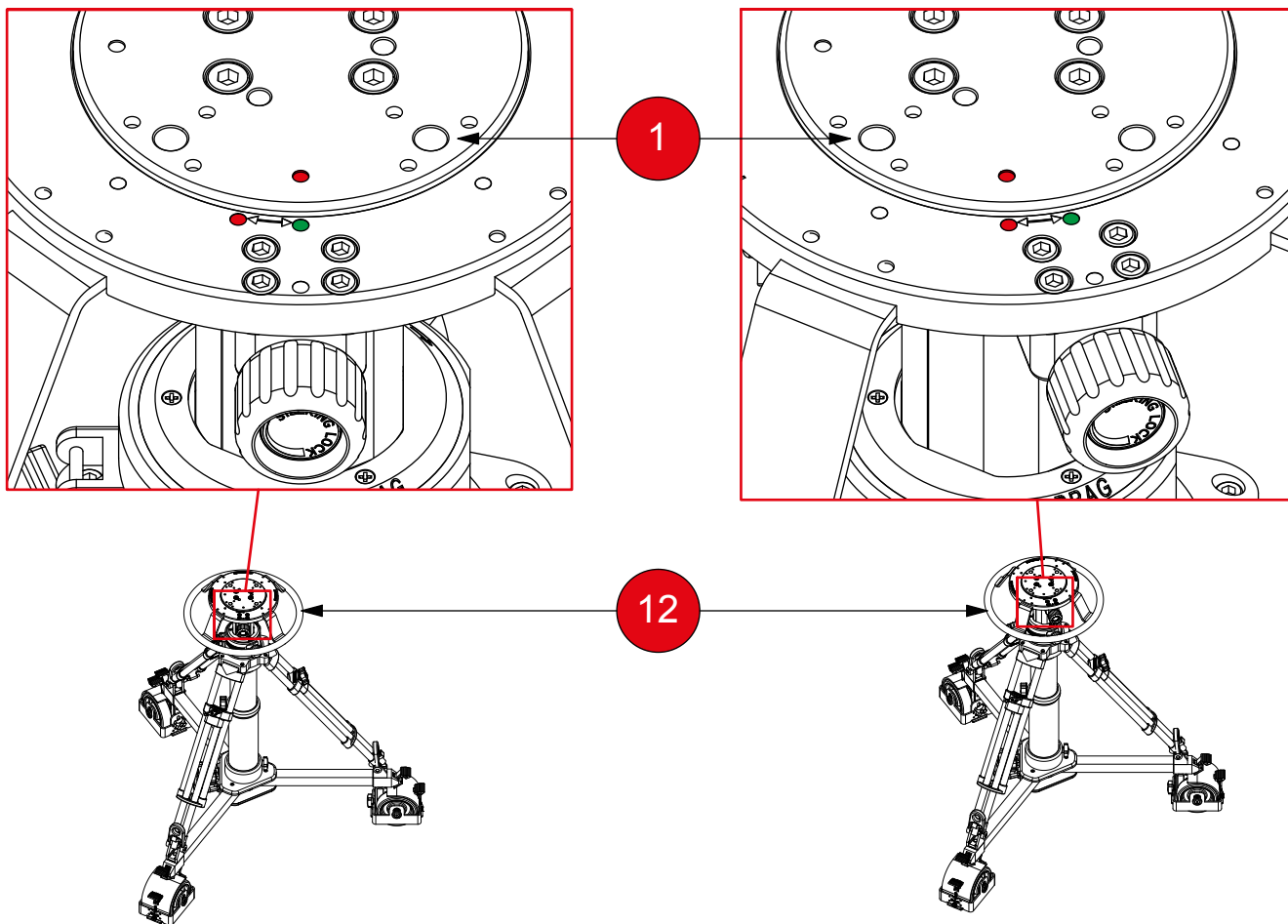

Lock the steering wheel with lock knob (11) to avoid the steering wheel disconnection from the column. While operating never unlock the steering wheel.



! There is a potential risk of fingers being trapped between the upper and lower sections of the Pedestal. When the Camera is being lowered and particularly when pressurized air is released; do not insert fingers into this area at such time.

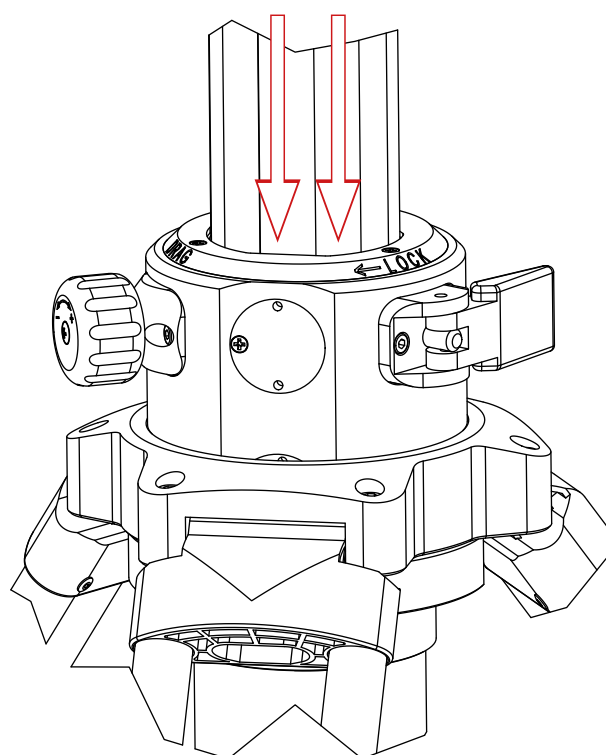

3.2 MOUNTING THE CAMERA

Lock the wheels by pushing down the lock lever (25) on each wheel.

Lower the column pushing it down and lock the safety latch (19) to the safety hooking bar (3).

Fix the pan and tilt Head directly on the top of the Pedestal or – if needed - using one of the accessories (see 2.2 Compatible equipment – Optional accessories) and secure the 4 retaining bolts (E) underneath the steering wheel with the Allen key (F) on the mounting plate (18).

Place the Camera on the pan and tilt Head and add all required additional equipment (lens, prompter, viewfinder, pan bars, etc).

Release the safety latch (19).

3.3 PRESSURIZING THE PEDESTAL AND BALANCING THE LOAD

The compressed air provided to the product must be dry, without oil and dust.

The pneumatic power should be provided through the intake valve (29) using the manual pump (C) which is included with the product or by means of an air-compressor. Remove valve cap and inflate the Pedestal.

The column should be filled with clean pressurized air or nitrogen until it compensates the weight of the Camera configuration.

To pressurize the Pedestal connect either the manual air pump provided with the system or the air-compressor to the intake valve (29), by screwing in the pump connection.

Inflate the system until the column rises and reaches and maintains the top upper position. Remove the air intake connection.

Bleed the air excess, pushing the pin in the intake valve (29) with the reversed cap until the Camera moves freely up and down through the entire range of the column stroke. The Camera is now balanced.

Recap the valve (29).



! Before pressurizing the Pedestal it is necessary to unlock the column by releasing the safety latch (19).

4. USING THE PEDESTAL

The total height of the system can be increased by extending the central column (4) and the tripod legs (14). This operation should be carried out prior to the head and camera installation. Extend to the desired height the telescopic elements of the central column and tripod legs by releasing the locks (5) and (6). Once reached the desired height lock all levers back. If correctly balanced the column should move without any resistance throughout the stroke capability.

In case one should need some resistance to the stroke, regulate the column damping by rotating the drag knob (13).

The drag control knob (13) is not a lock or a brake. Use the stroke lock (31) to block the column.

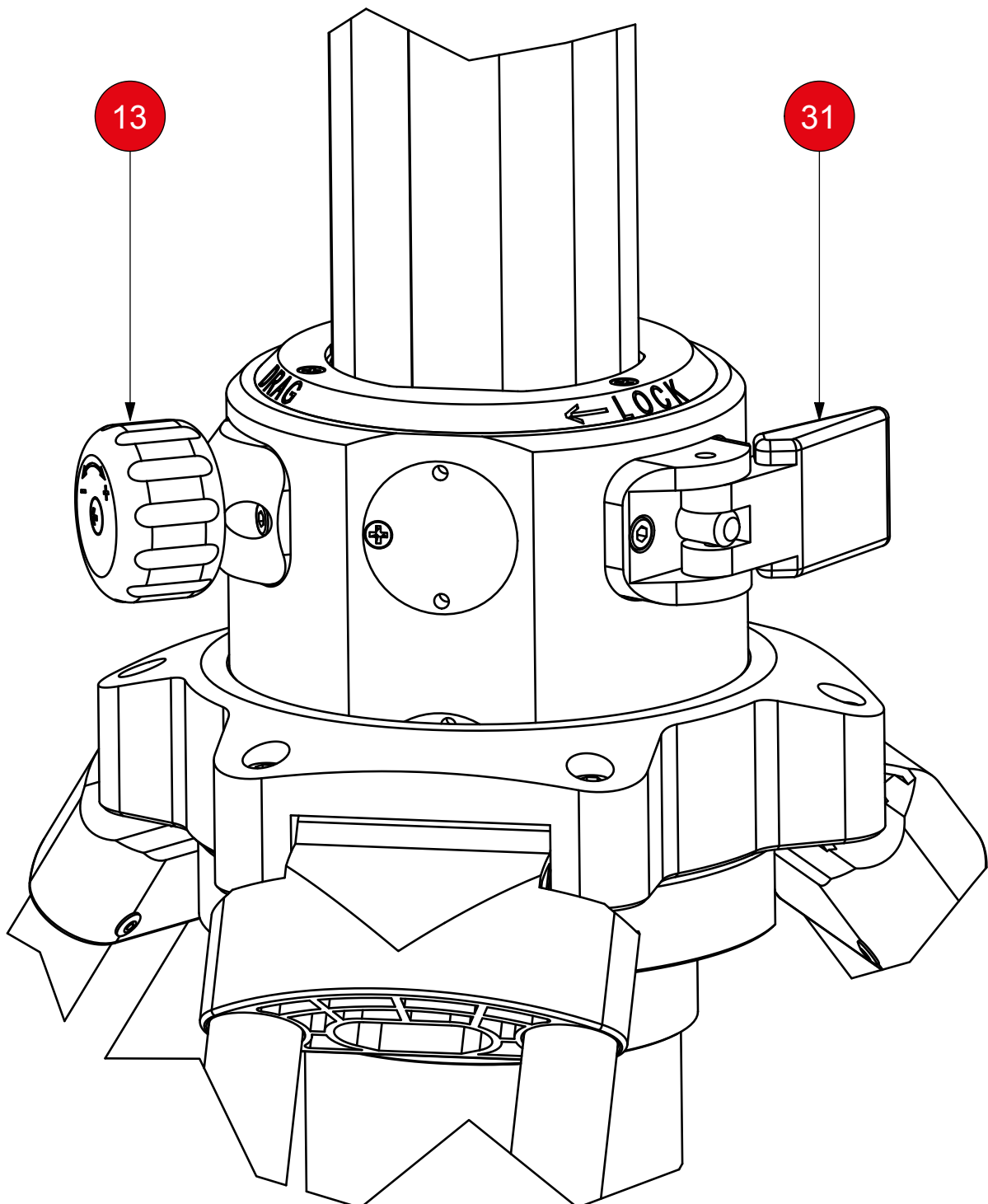

4.1 CABLE GUARDS

There is the risk of interference with cables or other obstacles under the Pedestal rubber wheels. A cable guard (26) has been installed around each wheel to minimize this risk of interference.

For height regulation from the floor loosen the cable guard knob, lift or lower the cable guard (26), then tighten the cable guard knob again. This system allows a variable height of protection from the floor 0 mm to ± 15 mm. (The zone of interference is equal to 80 mm, complying to prospect 1 of standard UNI EN ISO 13857:2020).

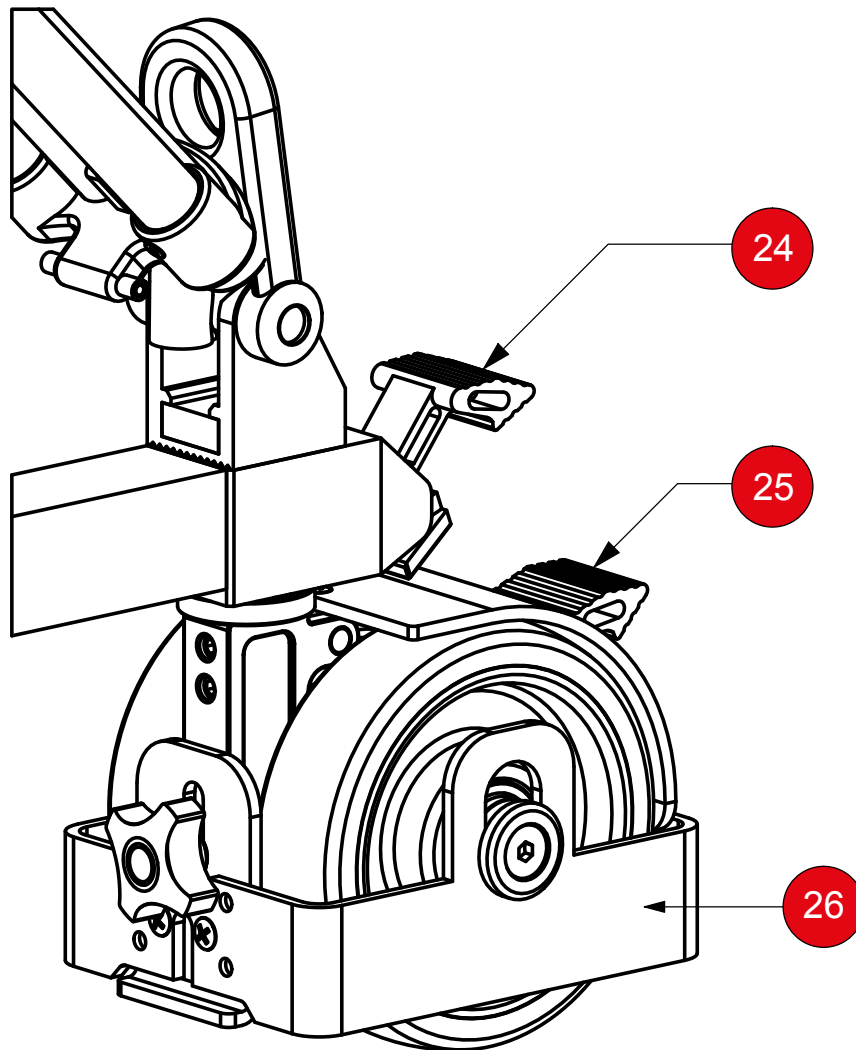

4.2 TRAVELLING

To wheel Pedestal into position, simply grasp steering wheel (12) and push.

The casters rotate freely when lever (24) is raised. By lowering lever (24) the casters can be locked into six different positions at 60° intervals. The wheels can be locked individually or all together in the same direction if the pedestal needs to track in a straight line.

To block all wheels and hence Pedestal movement, lower levers (25).

4.3 SAFETY PRECAUTIONS

The Pedestal is equipped with safety systems designed to eliminate the risk of injury to the operators or other surrounding people.



! The Pedestal has been designed to respect ergonomic principles to allow operators to use it without any physical exertion. This includes working conditions with minimum strain, movements, frequency of routines to avoid any physical and psychological discomfort.

! The presence of safety systems does not exonerate Pedestal operators from taking the utmost care to avoid any action that might endanger themselves or their machine. In particular, the operator must never come in contact with the Pedestal moving parts.

! It is absolutely forbidden to modify or remove any of the Pedestal safety systems.

All pneumatic components have been designed for high working precision and will last as long as the Pedestal itself. The pneumatic assembly is located in the internal part of the column and therefore protected from intentional and accidental damages.



! It is absolutely forbidden to modify all the pressure valves in any way whatsoever. Incorrect pressure valve settings could cause malfunctions or breakdowns in the pedestal components and could also seriously endanger its operators.

The column is fitted with a maximum pressure valve, which prevents air pressure rising above maximum level in order to protect the machine from malfunctions or breakdowns.

The maximum safety valve pressure is set at 10,5 bar and all column component dimensions have been selected to tolerate an operating pressure up to that level.



! The Pedestal must be used according to the instructions indicated in this manual.

The operators must take care to avoid creating potential dangerous situations for both the operator and others.

Anyone who operates the Pedestal must be thoroughly trained in the correct methods of use and its safety features.

Furthermore they must be informed of the present documentation relevant to their work.

During ordinary maintenance to the Pedestal, we recommend to follow the indications in the current section.



! All maintenance on the Pedestal must be carried out by competent and instructed personnel on the operative and safety methods of the Pedestal.

! Do not carry out any maintenance when the Pedestal is moving, and always check that the pressure valve gauge indicates minimum pressure inside the column (consider the minimum value is about 2 bars).

! Items whose center of gravity (CG) is too close to the rim of the casted base (Jib arms, Teleprompters) could cause the Pedestal to tip over eventually while moving the pedestal; optional foot ring is therefore recommended

Below are possible residual risks:



! There is a potential risk of trapping your hands between the moving section of the column and the column itself.

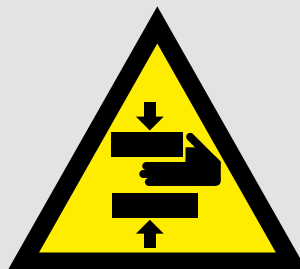

5. DISASSEMBLING AND STORAGE



! Before disassembling ensure that the load has been removed.

The Pedestal can be disassembled for transport and storage. Proceed as follows:

- Lock the casters position along the skid leg with levers (24).
- Lock the three wheels with the wheel locks (25).



! ATTENTION: beware of the column rebound when the load is removed.

- Remove the load (camera, lens, monitor, etc.).
- Depressurize the Pedestal to 1,5/2,0 bar (total bleeding is not compulsory).
- Open the safety latch (19) and push down the column (2) to engage the safety latch (19) to the safety hooking bar (3).
- Loosen the tripod leg levers (5) and the skid clamp (20).
- Lift the one stage column and the steering wheel assembly, extend the tripod legs (14) in the upper position and lock the tripod leg levers (5).
- The connection element (7) must stay connected to the column (4).
- Unlock the three rubber hooks (22), detach foot of one of the three tripod legs (21) inserted in seat (23).
- Lean the column assembly sideways - see **red arrow** - and detach the other two tripod legs.

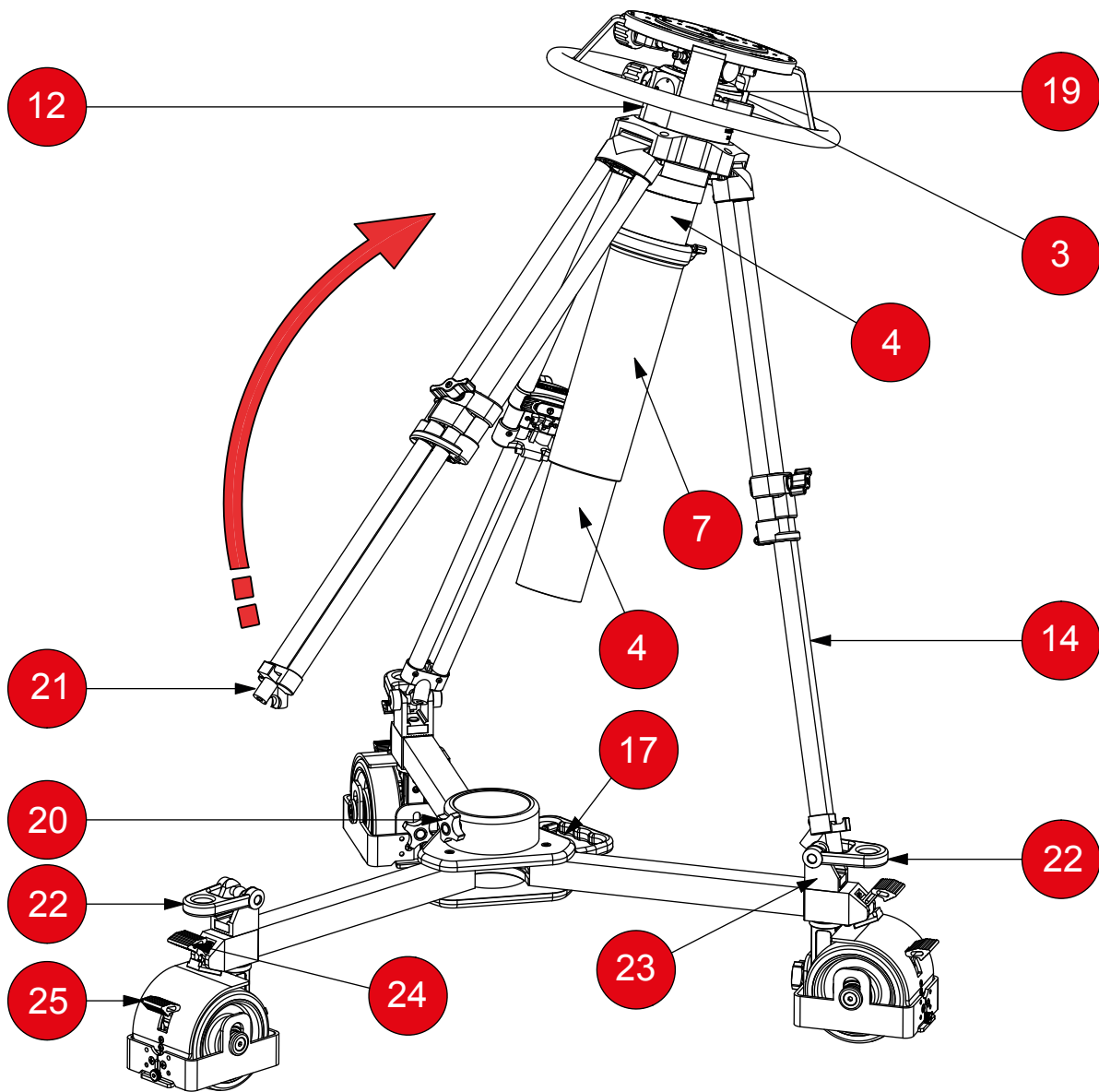

- Bring together the three tripod legs inwards (14).
- Loosen the tripod leg levers (5) and carefully place the column on the ground, possibly on a soft surface to avoid damaging the column: close the tripod legs (14) to their minimum length and lock the levers (5).
- Remove the steering wheel (12) from the steering wheel support (1) by unlocking the steering wheel with lock knob (11) and rotate the steering wheel (12) till the green mark couples the red mark on the steering wheel support (1).

- Lift the steering wheel (12) by pulling it out from the steering wheel support (1).

- Unlock lever (17) and fold the skid base (16).

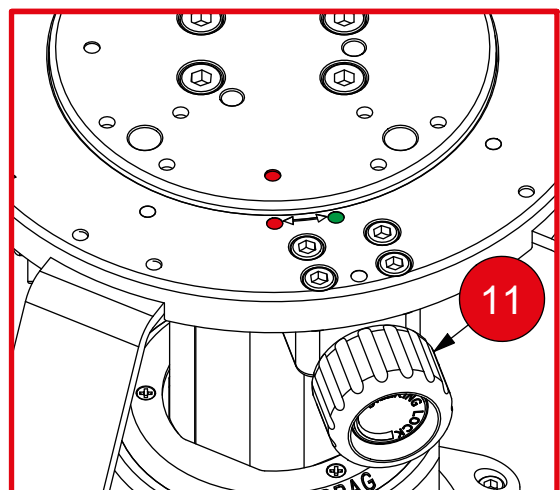
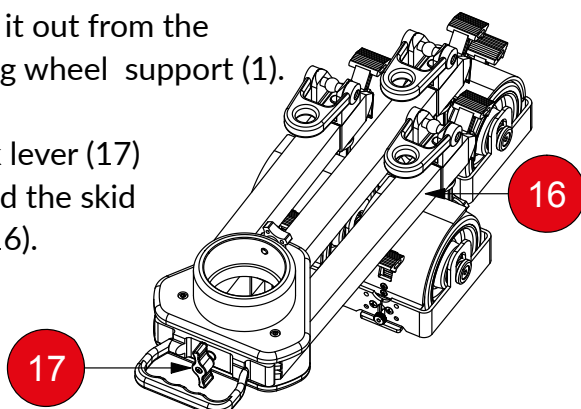

6. SERVICE

The Pedestal has been designed and built in a way to reduce as much as possible any maintenance, and to ensure problem-free efficiency over time.

After any maintenance operation, the Pedestal must be tested to ensure that it is working properly.



! Before starting any maintenance operation the Pedestal must be detached from any air supply line and the column completely depressurized as indicated in section 5.

6.1 ROUTINE MAINTENANCE

The pneumatic system does not require particular maintenance.

It is advisable to check the conditions of the inflating connection and of the in/out valve (29).

Use a damp cloth and no harsh cleaning product to remove dust, grease or other substances. It is particularly important to keep the wheels clean so that they can rotate freely.

Pedestal components should be carefully periodically inspected and any damaged part immediately replaced to prevent failures that might compromise the safety of the Pedestal.

6.2 EXTRA MAINTENANCE AND SPARE PARTS

Whatever extra maintenance requires to be carried out by **CARTONI's** own technical servicing staff or an authorized service station appointed by **CARTONI S.p.A.**

Information on authorized service station staff can be obtained by contacting **CARTONI S.p.A** or www.cartoni.com.

For fast, effective problem solving **CARTONI S.p.A.** should be informed of the Pedestal model, the serial number and the nature of the defect or its visible symptoms when the problem arises.



! All warranty conditions are invalidated should any repair operation be attempted by anyone not authorized by **CARTONI S.p.A.**

All spare parts should be ordered from **CARTONI S.p.A.** which will either supply them directly or indicate where they may be obtained.

Remember that repairs should only be carried out by persons employed or authorized by **CARTONI S.p.A.** All warranty conditions are invalidated should any parts be different from those originally mounted on the Pedestal.

6.3 DECOMMISSIONING

In case the Pedestal becomes beyond repair it should be placed off service or at least clearly labeled as “out of order”.



Since the Pedestal is largely made of steel and aluminum, most of its material can be re-cycled.

Once a Pedestal is decommissioned, it is advisable to separate its various materials for differentiated utilization or disposal.

Since none of the materials used on the Pedestal are toxic or may cause a risk to the health of its operators, they can be handled without the need for any special precautions.



! The dismantling of the Pedestal at the end of its life must be carried out by competent and trained personnel.

6.4 ENVIRONMENTAL PROVISIONS

This product is manufactured with entirely recyclable materials.

It should be treated in accordance with European Union Waste of Electrical and Electronic Equipment (WEEE) Directive (2012/19/EU).

For disposal please refer to the provisions for waste collection enforced in your country.



COMMERCIAL OFFICE
VIA GIUSEPPE MIRRI, 13
00159 ROME (ITALY)

CARTONI S.P.A.
www.cartoni.com
PHONE: +39 06 4382002
FAX: +39 06 43588293

REGISTERED OFFICE
VIA DI PORTONACCIO, 33/B
00159 ROME (ITALY)
cartoni@cartoni.com
cartoni-spa@pec.it

CARTONI
PROFESSIONAL CAMERA SUPPORT