

Atlas V2 Video Production Camera Cart (ATLS-V2-38)

Assembly Manual



What's In The Box

Please inspect the contents of your shipped package to ensure you have received everything that is listed below.

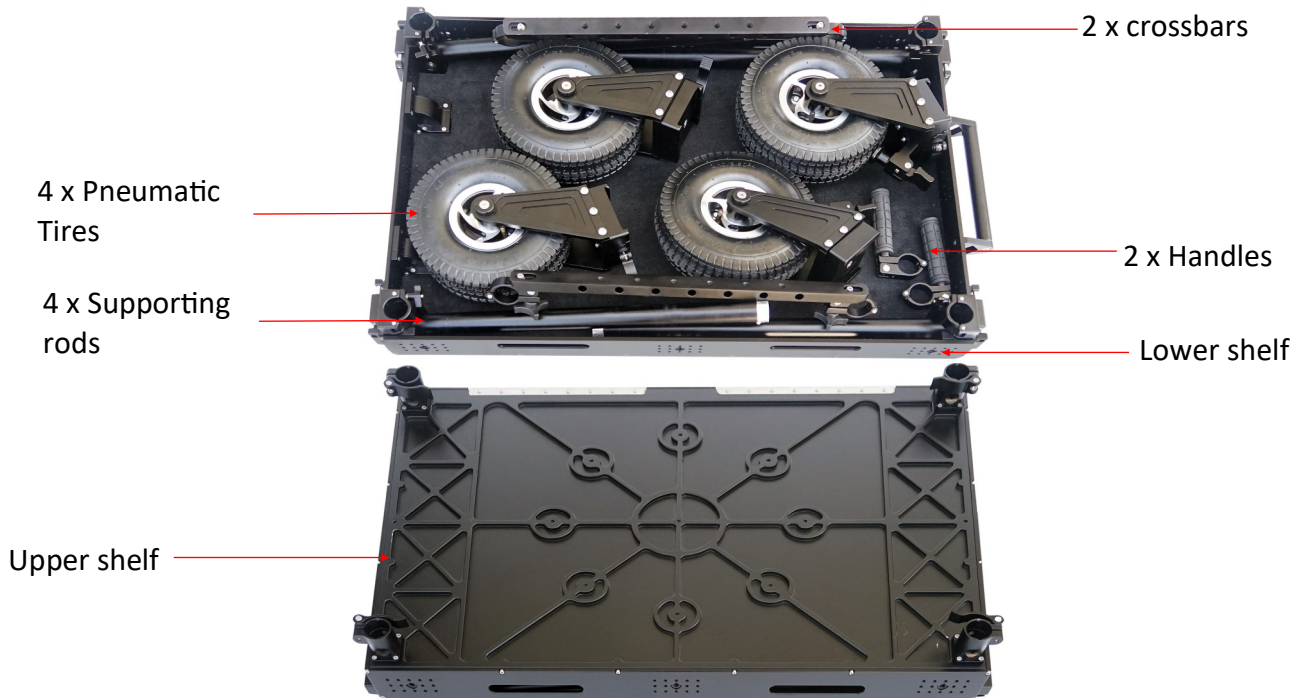

All rights reserved.

No part of this document may be reproduced, stored in a retrieval system, or transmitted by any form or by any means, electronic, mechanical, photo-copying, recording, or otherwise, except as may be expressly permitted by the applicable copyright statutes or in writing by the Publisher.

Atlas Cart Setup

- Open all the 4 locks of Trolley to take out all the parts, as shown in image.



Attaching Pneumatic Tires

Slide the wheels on Dovetail bracket mounted at the base of the lower Shelf of Cart and secure the tires with locking knob.



NOTE: *Specially designed Foot Brakes help set the Cart in the desired position or keep the Cart in a static place (non-movable). You can use Brakes as per your requirement.*



- Unfold all four rods and secure with provided locking clamps.



- Place the upper shelf over the rods and tighten the knobs properly, as shown in image.



- Press the pin button both side if you want to remove the Upper shelf.

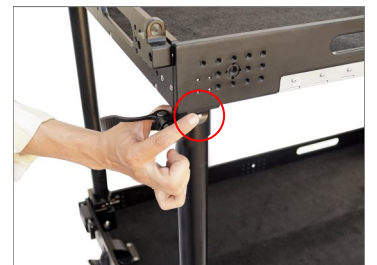

Attaching Handle

Insert the handle onto the rods, set the required height, and secure properly.



- Insert the crossbar and secure with provided knob.



- There is a provision to unfold the lip by releasing the inner locking pin.



YOUR PROAIM ATLAS V2 VIDEO PRODUCTION CAMERA CART ALL DRESSED UP AND READY TO GO!



(SHOWN WITH OPTIONAL ACCESSORIES)

Warranty: We offer one year warranty for our products from date of purchase. Within this period of time, we will repair it without charge for labor or parts. Warranty doesn't cover transportation costs nor does it cover a product subjected to misuse or accidental damage. Warranty repairs are subjected to inspection and evaluation by us.

Liability: We are not liable for damage caused by products that we do not supply or from mishandling in transit, accident, misuse, neglect, lack of care of the product, or service by anyone other than our company.

Contact Us: In case of any kind of dissatisfaction, please Contact us immediately and we promise our utmost support and care until you use our product.